

Ellie

Quick Reference Guide

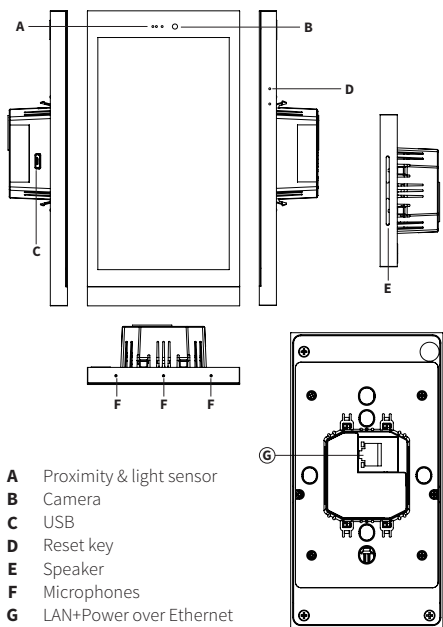

Ellie is designed to be wall mounted in portrait orientation.

Ellie requires a minimum mounting depth of 22mm from the back side of Ellie plus room for cable/s. Power is supplied by Power Over Ethernet (PoE). PoE must meet the IEEE 802.3af standard. Ellie connects to the local network via a hard wired Ethernet connection.

1 Installing Ellie

a. Mounting height

The recommended mounting height for Ellie is 1450 mm -1650 mm (57"- 65") above the finished floor.

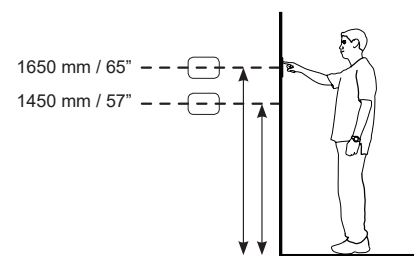

d. Installing the mounting bracket

Using the included #5-24 screws to mount the mounting bracket onto the EU/CH single-gang junction box.

Using the included #6-32 screws to mount the mounting bracket onto the US/NEMA single-gang junction box.



EU/CH single-gang junction box:

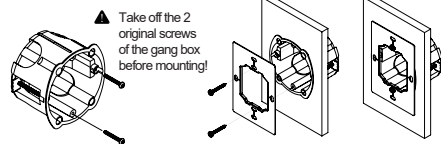

US/NEMA single-gang low-voltage mounting bracket:

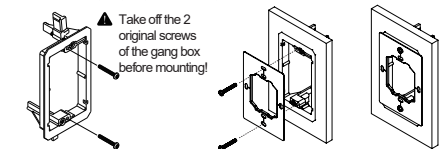

e. Connecting Ellie to power and Ethernet

PoE Connection

PoE connection requires the IEEE 802.3af standard. Use a network switch or PoE injector that meets this standard.

Connect Ellie using a standard T568A or T568B Ethernet cable from the network switch to the LAN/PoE connector on the back of Ellie.

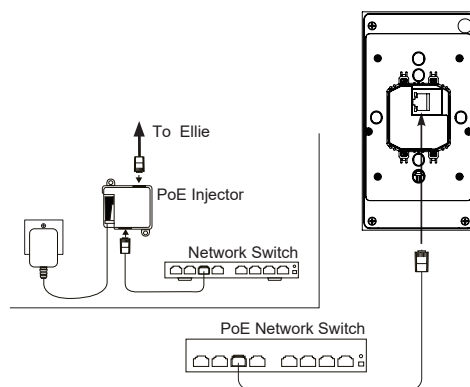

b. Rough-In

Ellie has been designed to mount to a EU/CH, NEMA single-gang junction box, US/NEMA standard single-gang junction box.

The mounting bracket, included in the box, should be attached with included screws (#5 for EU/CH; #6 for US).

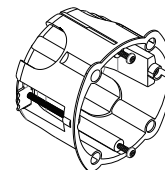

EU/CH single-gang box

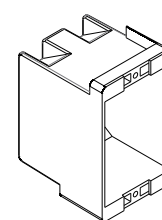

US/NEMA single-gang box

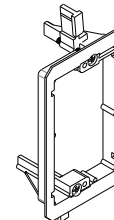

US/NEMA single-gang low-voltage mounting bracket

c. Portrait Mounting

Install the single-gang box junction box or low-voltage mounting bracket in its normal orientation.

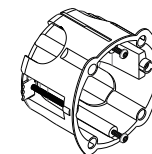

EU/CH single-gang box

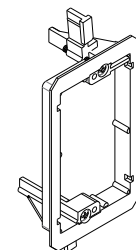

US/NEMA single-gang low-voltage mounting bracket

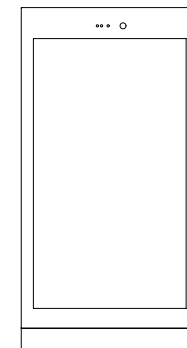

f. Installing Ellie on the wall

Position Ellie for the portrait mounting, align the mounting bracket hooks with Ellie mounting slots and gently press it towards the mounting bracket/wall.

Ellie snaps in when pushed to its mounting bracket.

CAUTION: DO NOT PRESS DIRECTLY ON THE SCREEN
 When installing on to the mounting bracket. Press only on the frame edges.

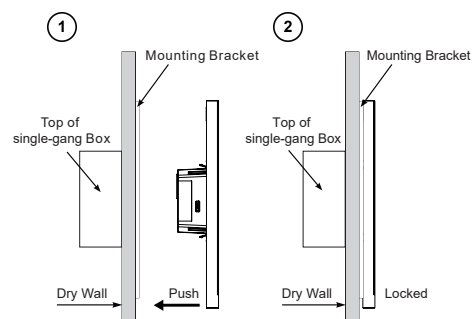

g. Mounting Ellie

Align the mounting bracket hooks with the mounting slots and gently press Ellie towards the mounting bracket/wall.

Make sure the mounting hooks are properly engaged.

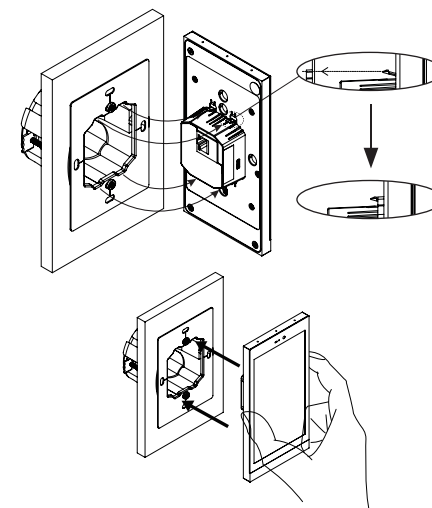

2 Powering up Ellie

Ellie will automatically power on when power is applied. Wait for the unit to boot up completely.

When connected to a switch by Ethernet cable Ellie will acquire a network address via DHCP and automatically connect to the system.

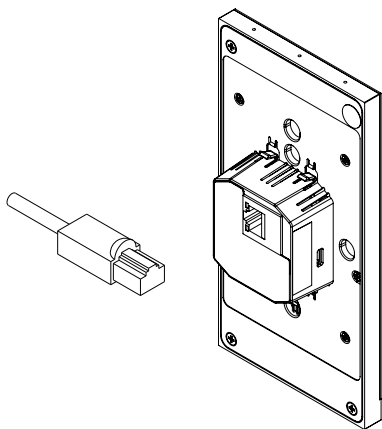

3 Removing Ellie

Follow the step 1 and 2 in order to remove Ellie from the wall.

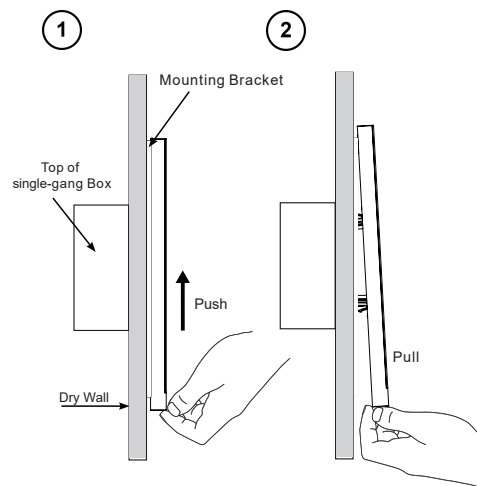

4 Reset button

If you want to restart Ellie, shortly press the recessed reset button (upper button). After +/- 10" the Basalte logo will appear and Ellie will restart.

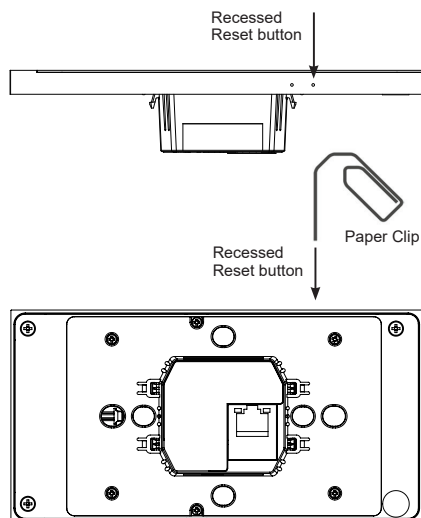

Thank you for using Ellie as part of your intelligent home.

Ellie has been designed to provide years of trouble free operation when wired and installed properly.

Ellie has been designed for installation in low humidity indoor environments and should never be installed outdoors or in high humidity areas.

Included in the box

- 1x Ellie touch panel
- 1x mounting bracket
- 2x #5-24 Mounting Screws for EU/CH single-gang box
- 2x #6-32 Mounting Screws for US/NEMA single-gang box

ellie

basalte

Important Safety Instructions

1. Read, understand and follow ALL safety and installation instructions included in this manual. Failure to follow the included documentation may damage the product and will void manufacturer's warranty.
2. Follow ALL installation guidelines included with the product. Installation of the product in high humidity environments, in close proximity to heat sources and/or non-recommended locations WILL impede, interfere and/or damage the intended operation of the product.
3. Only use attachments and accessories which have been specified for use by the manufacturer.
4. The use of abrasive, liquid or solvent based cleaning fluids WILL damage the product.
5. Product Servicing may ONLY be completed by authorized or certified service centers & personnel. For a complete list of product servicing options, please follow instructions included in the product documentation and/or contact the basalte support for details.

FEDERAL COMMUNICATIONS COMMISSION INTERFERENCE STATEMENT:

This equipment has been tested and found to comply with the limits for a Class B digital device, pursuant to part 15 of the FCC Rules.

These limits are designed to provide reasonable protection against harmful interference in a residential installation. This equipment generates, uses and can radiate radio frequency energy and, if not installed and used in accordance with the instructions, may cause harmful interference to radio communications. However, there is no guarantee that interference will not occur in a particular installation. If this equipment does cause harmful interference to radio or television reception, which can be determined by turning the equipment off and on, the user is encouraged to try to correct the interference by one or more of the following measures:

- Reorient or relocate the receiving antenna.
- Increase the separation between the equipment and receiver.
- Connect the equipment into an outlet on a circuit different from that to which the receiver is connected.
- Consult the dealer or an experienced radio/ TV technician for help.

Made in Belgium

basalte is a registered trademark of basalte bv.

basalte bv

hundelgemsesteenweg 1a | 9820 merelbeke | belgium
tel +32 9 385 78 38 | info@basalte.be | www.basalte.be