

CasaConnect KNX Set 10

KNX Starter Set

Technical data and installation instructions

Article number 71210

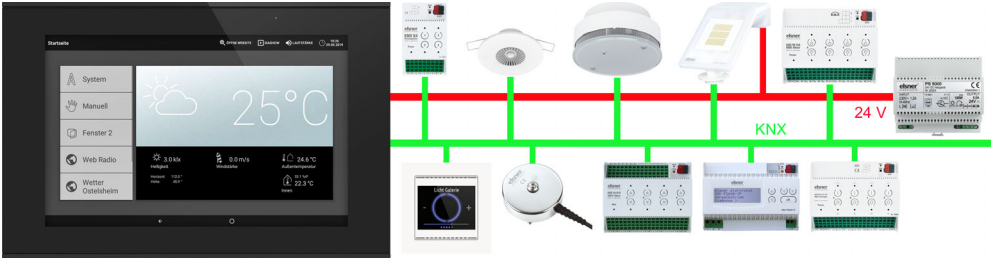

1. Area of use

The **KNX Starter Set CasaConnect KNX Set 10** is a preconfigured KNX complete package for apartment automation comprising the CasaConnect KNX central controls and other KNX operating devices, KNX sensors and KNX actuators. Lights, heating, sun protection and ventilation can be automatically controlled and manually operated with the **CasaConnect KNX Set 10**. In addition, safety functions such as smoke and water leak alarms can be realised.

The **KNX Starter Set CasaConnect KNX Set 10** supplied is a ready-projected and addressed, i.e. the devices only need to be installed and, as soon as they are connected to the KNX bus line, are communication-ready.

After the individual settings of the functions on the display of the CasaConnect KNX central controls, automatic mode can be set.

Please use the CasaConnect KNX operating instructions in order to match the automatic functions to your needs and to facilitate comfortable manual operation.

Functions and properties of the CasaConnect KNX Set 10:

- **Simple KNX automation** of an apartment or house
- **No ETS** needed because a preconfigured KNX project is supplied. Extensions to the KNX system or changes to individual devices of the set, e.g. change to labels, function adjustments, change to function assignment of binary inputs, can be implemented with the KNX software ETS from Version 5
- Operation and status query on the **smartphone App**
- **Extendable** with other KNX devices
- Optimum interaction of shading, heating, cooling, ventilation
- **Remote access** to the CasaConnect KNX required via network for system set-up, diagnostics and activation by the user
- **Presence simulation**
- **Safety module** (or messages from an alarm system) with memory for event log
- **HCL(Human Centric Lighting) controls:** The biodynamic light controls change light colour and brightness over the course of the day. These light controls can support well-being
- **24 Scenes** for calling up individually set actuation positions and switching conditions. With a scene, multiple motors and devices are addressed simultaneously so that a suitable atmosphere is created with the touch of a finger ("TV", "Eating", etc.)

1.1. Scope of delivery

The **CasaConnect KNX Set 10** is a KNX starter-set, i.e. it is not possible to return individual articles for a credit or replacement.

	Art. No.	Set 10
CasaConnect KNX central control and operating unit with SD card in card slot	71200	1x
P04-KNX-GPS weather station	71230	1x
KNX PS640-IP power supply	70142	1x
PS5000 power supply	20203	1x
Cala Touch KNX T room controller	70800	4x
Intra-Sewi KNX TH-L-Pr presence detector	70681	2x
Salva KNX basic smoke alarm	70405	3x
Leak KNX basic leak sensor	70315	1x
KNX K4 heating controls	70320	1x
KNX DALI L4 bc 16 A DALI light controller	70580	1x
KNX S4-B10 230 V sun protection controls	70530	2x
KNX R8 16 A switching actuator	70570	1x

1.2. Extent of functions

Among other things, the **CasaConnect KNX Set 10** offers the following functions:

Temperature regulator:

The heating is connected to the KNX K4 (4 outputs).

The temperature mode change (Comfort, Standby, Eco) settings are adjusted in the CasaConnect KNX menu under
System > Set-up automatic > Temperature regulator > Time switches Mode

The current room temperature value comes from the Cala KNX T room controller. This is where the actual controlling takes place and the setpoint can be set.

All room Temperature regulators are aligned to single-stage heating. If other types of control are needed (two-stage heating, single-stage heating + single-stage cooling, etc.), the conversion must be performed via ETS from Version 5.

Fan:

To use fans, the programming in the ETS, e.g. through the integrator, is needed.

Sun protection / window controls:

The drives for shutter, blind, awning or window are connected to the KNX S4-B10 (8 outputs).

First of all, which function is desired (shutter, blind, awning or window) is selected. The setting is applied in the CasaConnect KNX menu under
System > Set screen > Function block A > Drives

Automatic is then set.

System > Set automatic mode > Awning | Blind | Shutters | Window > ...

The indoor temperature value can either be provided by a Cala KNX T room controller or by an Intra-Sewi KNX TH-L-Pr ceiling sensor.

Outdoor temperature, rain report, time and position come from the P04-KNX-GPS weather station.

Light / socket / device controls:

Up to 4 luminaires (luminaire groups) can be connected via DALI bus to the KNX DALI L4 bc 16A. They can be switched or dimmed either at the Cala KNX T room controller or the CasaConnect KNX central controls.

Manual > All > Dali Lightgr. X

The outputs are preconfigured as standard to Dali dimming. If an output is only used for switching, the relevant output can be converted in the CasaConnect KNX system menu.

System > Set screen > KNX settings > Function block A > Lighting > Dali Lightgr. X > Type of output

Up to 8 luminaires can be connected to the KNX R8 16 A switching actuator. They are switched directly either at the Cala KNX T room controller or the CasaConnect KNX central controls.

Manual > All > Actuator 1 SAX

The switch actuator outputs on the KNX R8 16 A can also be used, for example, for switchable sockets or for switching off domestic appliances.

In two rooms the luminaires can be automatically switched when people are in the room by the Intra-Sewi KNX TH-L-Pr presence detector, which is directly connected to the KNX R8 16 A switching actuator.

In addition, periods can be defined, in which the light is on.

System > Set-up automatic > Light > ... > Timed switching

Manual operation:

In addition to automatic mode, manual operation at the Cala KNX T room controller or the CasaConnect KNX central controls is possible.

Water leak:

With the Leak KNX basic leak sensor, a water alarm (e.g. because of a broken water pipe) can be detected and displayed with the text message "Leak Alarm" when clicking on the alarm icon at the top right of the CasaConnect KNX central control start page.

Smoke warning:

If the 3 Salva KNX basic smoke detectors in a room detect smoke, they send the message "Smoke alarm" via the KNX-Bus to the CasaConnect KNX central controls. This message is also displayed when clicking on the alarm icon at the top right of the start page and has to be acknowledged. A message is also displayed on the central controls if a smoke detector's battery is empty.

Safety module:

If the safety module is activated externally:

Safety module > External activation

the motion detector is used as an intruder detector and an intruder alarm is triggered on the CasaConnect KNX as soon as the presence of people is detected, which can be displayed by clicking on the alarm icon and acknowledged. If an email address is saved:

System > System setting > Email message

an email can be set if the intruder alarm is triggered:

System > Set screen > Safety module > Alarm > Recipient for notifications > Intruder alarm

Presence simulation:

You can call up to 16 events with the presence simulation simultaneously or consecutively, to give the appearance that people are in the building. A settable delay for the start time makes the simulation more realistic.

System > Set screen > Presence simulation.

1.3. Technical specifications and other information

See corresponding datasheets at <https://www.elsner-elektronik.de/shop/de/download/>

The products conform to the conditions of the EU Directives.

2. Safety and operating instructions

2.1. Installation notes



Installation, testing, operational start-up and troubleshooting should only be performed by an electrician.



CAUTION!
Live voltage!

There are unprotected live components inside the device.

- National legal regulations are to be followed.
- Ensure that all lines to be assembled are free of voltage and take precautions against accidental switching on.
- Do not use the device if it is damaged.
- Take the device or system out of service and secure it against unintentional use, if it can be assumed, that risk-free operation is no longer guaranteed.

The device is only to be used for the intended purpose described in this manual. Any improper modification or failure to follow the operating instructions voids any and all warranty and guarantee claims.

After unpacking the device, check it immediately for possible mechanical damage. If it has been damaged in transport, inform the supplier immediately.

The device may only be used as a fixed-site installation; that means only when assembled and after conclusion of all installation and operational start-up tasks and only in the surroundings designated for it.

Elsner Elektronik is not liable for any changes in norms and standards which may occur after publication of these operating instructions.

2.2. Safety information about automatic and alarm functions



WARNING!

Risk of injury from automatically moving components!

System parts may start automatically as a result of the automatic controls and can put people in danger.

- People must not enter the movement range of motorised moving parts.
- If staying outside the building, make sure that the return path/access is not blocked (danger of being locked out).
- During maintenance and cleaning work, switch off the system.

Rain alarm for automatically controlled windows:

If rain is entering, it may be some time before rain is detected by the sensors in the system, depending on the amount of rain and outside temperature. In addition, a closing time for electric windows or sliding roofs has to be included in the calculation. Moisture-sensitive objects should therefore not be placed in areas where they could be damaged by entering precipitation.

Icing-up of rails of the shades:

Be aware that the rails of blinds, awnings and shutters, which are fitted outside, can ice up. If a motor is then moved, shades and motors can be damaged.

2.2.1. Power outage, maintenance work, etc.

If there is a power outage or bus voltage failure, no commands, safety or protection functions (e.g. secure position in there is a wind or rain alarm) can be executed in the KNX system! If the full extent of functions is also to be guaranteed if the mains power fails, an emergency generator with corresponding switching from mains to emergency operation should be installed on site.

Settings stored in the program are also retained after the power outage.

After a restart (e.g. restoration of power after a power outage or after a manual reset), motors and devices, for which an automatic reset is set, are in automatic mode.

3. Installation

The **KNX Starter Set CasaConnect KNX Set 10** has been defined for this without ETX being installed and commissioned (see chapter 3.1.).

However, expansions to the **CasaConnect KNX Set 10** or changes to individual devices of the set are possible at any time (see chapter 3.2.).

3.1. Installation without ETS

The ETS project has been designed in such a way that it comprises an outdoor area, a hall with subdistributors and 5 rooms. The individual devices in the ETS project are located in these areas.

Each device is labelled with the physical address and thus has a unique identification. This address is also the unique allocation in the ETS. The distribution of the devices in the various rooms / areas can be seen in the following table. This allocation can also be varied without intervention in the ETS, e.g. the devices in room 2 (Leak KNX basic) and room 4 (Cala Touch KNX T, 10.1.53) can be installed in one room.

Name	Art. No.	individual address
Outer area		
P04-KNX-GPS weather station	71230	10.1.3
Hall		
Intra-Sewi KNX TH-L-Pr presence detector is connected to Switch light: Channel 7 of the KNX R8 16 A	70681	10.1.60
Salva KNX basic smoke alarm	70405	10.1.70
Hall - Subdistributor		
PS5000 power supply	20203	-
KNX PS640-IP power supply	70142	10.1.0
KNX S4-B10 230 V sun protection controls (Channel 1- 4)	70530	10.1.10
KNX S4-B10 230 V sun protection controls (Channel 5- 8)	70530	10.1.11

KNX R8 16 A switching actuator	70570	10.1.20
KNX DALI L4 bc 16 A DALI light controller	70580	10.1.30
KNX K4 heating controls	70320	10.1.40
Room 1 (2 Temperature regulators, 2 Dali light groups, 4 luminaires, 5 drives controllable)		
CasaConnect KNX central control and operating unit	71200	10.1.2
Cala Touch KNX T room controller is connected to Temperature regulator: Channel 1 of the KNX K4 Switch/dim light: Channel 1 of the KNX DALI L4 bc 16 A Switch light: Channel 1 of the KNX R8 16 A Switch light: Channel 2 of the KNX R8 16 A Drive control: Channel 1 of the KNX S4-B10 230 V Drive control: Channel 2 of the KNX S4-B10 230 V Drive control: Channel 3 of the KNX S4-B10 230 V	70800	10.1.50
Cala Touch KNX T room controller is connected to Temperature regulator: Channel 2 of the KNX K4 Switch/dim light: Channel 2 of the KNX DALI L4 bc 16 A Switch light: Channel 3 of the KNX R8 16 A Switch light: Channel 4 of the KNX R8 16 A Drive control: Channel 4 of the KNX S4-B10 230 V Drive control: Channel 5 of the KNX S4-B10 230 V	70800	10.1.51
Salva KNX basic smoke alarm	70405	10.1.70
Room 2		
Leak KNX basic leak sensor	70315	10.1.80
Room 3 (1 Temperature regulator, 1 Dali light group, 1 luminaire, 2 drives controllable)		
Cala Touch KNX T room controller is connected to Temperature regulator: Channel 3 of the KNX K4 Switch/dim light: Channel 3 of the KNX DALI L4 bc 16 A Switch light: Channel 5 of the KNX R8 16 A Drive control: Channel 6 of the KNX S4-B10 230 V Drive control: Channel 7 of the KNX S4-B10 230 V	70800	10.1.52
Salva KNX basic smoke alarm	70405	10.1.71
Room 4 (1 Temperature regulator, 1 Dali light group, 1 luminaire, 1 drive controllable)		
Cala Touch KNX T room controller is connected to Temperature regulator: Channel 4 of the KNX K4 Switch/dim light: Channel 4 of the KNX DALI L4 bc 16 A Switch light: Channel 6 of the KNX R8 16 A Drive control: Channel 8 of the KNX S4-B10 230 V	70800	10.1.53
Room 5		
Intra-Sewi KNX TH-L-Pr presence detector is connected to Switch light: Channel 8 of the KNX R8 16 A	70681	10.1.61

A push button can be connected to each Cala Touch KNX T room controller for each light channel, with which the light can also be switched or switched/dimmed. The sequence of the button inputs here corresponds to the sequence of the light channels.

Up to 10 contacts (bus button as switch) can be connected to the KNX S4-B10 230 V sun protection controls, e.g. magnetic contacts (10.1.10: contact 1-10; 10.1.11: contact 11-20). As a result, automatic window controls can be set up, for example, with window contact to the CasaConnect KNX central controls. This hardware must be provided on site.

In the scope of delivery, all 2 x 10 binary inputs are activated for use in the safety module. The function assignment per input is performed in the CasaConnect KNX system menu under

System > Set screen > KNX settings > Function block B > Alarm messages > Contacts > Alarm message A/B > Use in safety module

3.2. Installation with ETS

In order to configure or install the device of the **CasaConnect KNX Set 10** differently than as described in chapter 3.1, or to connect additional KNX devices, this is possible at any time with an adjustment in the ETS from version 5.

The ETS project is saved on the CasaConnect KNX's SD card. Elsner Elektronik is not liable for damage resulting from a change to the ETS project.

4. Commissioning

After connecting the bus voltage, some devices remain in the initialisation phase for a few seconds. During this period, no information can be received or transmitted via the bus.