

Operating Instructions Two-channel Venetian blind actuator



1. System information

This unit is a product of the *instabus*-EIB-System and corresponds to the EIBA Guidelines. Detailed technical knowledge acquired in *instabus* training courses is a prerequisite for the understanding of the system. The functions of the device are software-dependent. Detailed information on the software and the functions implemented and the software itself are available from the manufacturer's product data bank.

Planning, installation and commissioning of the device are effected with the help of EIBA-certified software.

An updated version of the product database and the technical descriptions is available in the Internet at www.jung.de.

2. Function

The two-channel Venetian blind actuator switches up to two independent Venetian or roller blind drive mechanisms via the *instabus* EIB. The device does not require any additional power supply.

Moving commands are given by the actuation of touch sensors or binary inputs of the *instabus* EIB system.

3. Safety instructions

Attention

Electrical equipment must be installed and fitted by qualified electricians only and in strict observance of the relevant accident prevention regulations.

To prevent electric shocks, disconnect the mains supply (by cutting out the circuit breaker) before working on the device.

Failure to observe any of the installation instructions may cause fire and other hazards.

For connection of motors only!

Hazards that may be caused by motor-driven components must be excluded by taking appropriate safety measures.

The device comes with undefined output switching states.



4. Important information

- For parallel connection of louver-blind/shutter motors, the instructions of the motor manufacturers must be observed. The motors might otherwise be irreparably damaged.
- Use only louver-blinds or roller shutters equipped with limit switches (mechanical or electronic). The limit switches of the motors connected must be checked for correct adjustment.

5. Characteristics

- Two independent channels for one Venetian blind motor each.
- Selectable mode of operation (Venetian or roller blind).
- Adjustable switch-over time for direction change (observe motor manufacturer's instructions).
- Adjustable running time for "Venetian blind up" travel.
- Priority assignment to incoming telegrams.
- Automatic sun protection for brightness-dependent moving of the Venetian blind to a parameterisable position.
- Logical interconnection of two sun protection objects.
- Control via four central functions.
- Moving to a parameterised Venetian blind or slat position for each channel.
- Separately adjustable safety position for each channel.
- Adjustable response to bus voltage failure and reappearance.

6. Connection

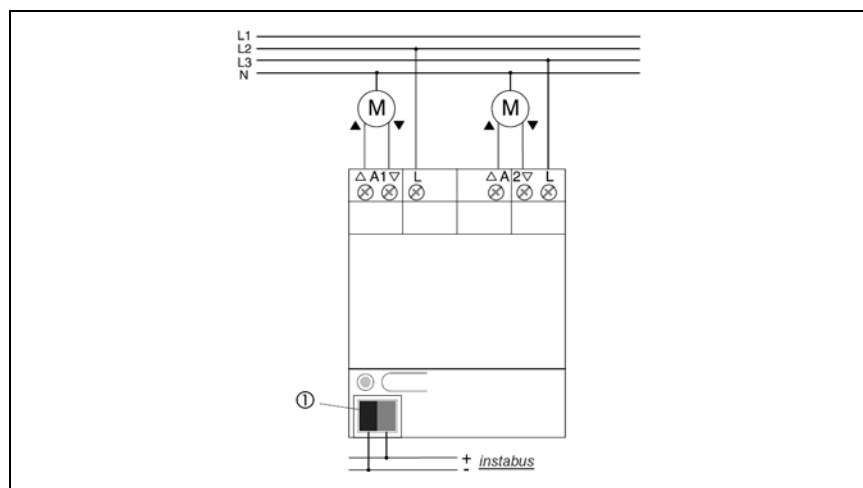

The bus terminal ① can be used for bus connection.

Establish connection of motors as shown in the schematic diagram.

You can connect various external conductors to the devices.

7. Cap

Slide the cap with the bus wires at the bottom over the bus terminal (fig. A) until it is heard to engage.

To remove the cap, push sideways and withdraw (fig. B).

The cap can be supplied as an extra part (Art. no. 2050 K).

Technical specifications subject to change.

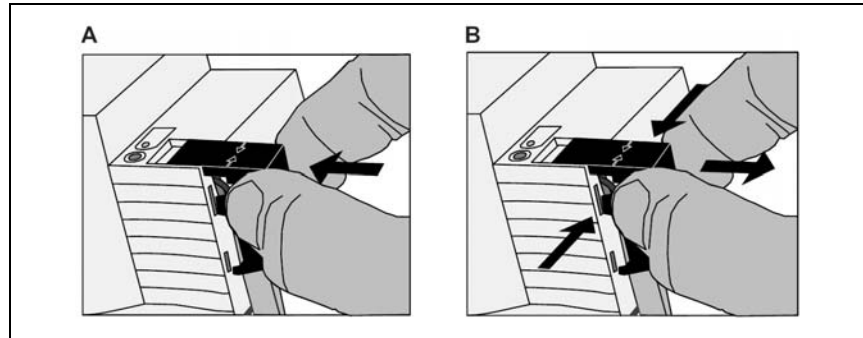

8. Technical Data

instabus EIB supply voltage :

21 - 32 V DC

instabus EIB power rating :

max. 150 mW

Connection

instabus EIB :

Motors :

instabus terminal
screw terminals
0.5 – 4 mm² single and
stranded wire without
ferrule
or 0.5 – 2.5 mm²
stranded with ferrule

Switching voltage :

230 V AC

Switching capacity :

6 A/AC-1

4 A, $\cos \varphi = 0,8$

Ambient temperature :

-5 °C ... +45 °C

Storage temperature :

-25 °C ... +70 °C

Installation width :

72 mm (4 modules)

Technical specifications subject to change.

9. Acceptance of guarantee

Our products are under guarantee within the scope of the statutory provisions.

Please return the unit postage paid to our central service department giving a brief description of the fault:

ALBRECHT JUNG GMBH & CO. KG

Service-Center

Kupferstr. 17-19

D-44532 Lünen

Service-Line: +49 (0) 23 55 . 80 65 51

Telefax: +49 (0) 23 55 . 80 61 89

E-Mail: mail.vki@jung.de

General equipment

Service-Line: +49 (0) 23 55 . 80 65 55

Telefax: +49 (0) 23 55 . 80 62 55

E-Mail: mail.vkm@jung.de

Instabus EIB equipment

Service-Line: +49 (0) 23 55 . 80 65 56

Telefax: +49 (0) 23 55 . 80 62 55

E-Mail: mail.vkm@jung.de

 The CE-Sign is a free trade sign addressed exclusively to the authorities and does not include any warranty of any properties.