

Interface UP RS232 for FT 1.2 Protocol UP 146 – Z1 5WG1 146-2AB11-Z1

Issued: August 2003

Product and Applications Description

The interface UP 146 – Z1 is available in the following colours matching the designs of the DELTA switches series DELTA profil:

DELTA profil, titanium white 5WG1 147-2AB11 - Z1

With its built-in plug-and-socket device, it enables a personal computer (AT compatible PC) to be attached for addressing, parameterising, visualising, logging and diagnosis of bus devices using the FT 1.2 protocol and a BCU 2.1.

With the interface it is possible to operate all bus devices in the whole bus system. It allows devices isolated access to the bus line when a specified transmission protocol has to be adhered to.

The connection to the PC is arranged between the 9-pin Sub-D-socket of the interface UP 146 – Z1 the COM 1 or COM 2 interface.

The interface is slid onto the bus coupling unit UP 114 (BCU 2.1) together with its frame (DELTA profil). It requires a bus coupling unit BCU 2.1 to work properly.

It is possible to e.g. remove a UP push button from its bus coupling unit UP 114 and replace it with an interface UP. This does not destroy the application program of the bus coupling unit UP.

The bus coupling unit UP 114 and frame are not included and therefore have to be ordered separately. Cut-out frames should be used for DELTA profil.

Application Programs

none

Example of Operation

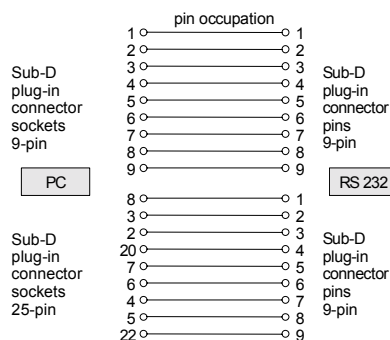

Technical Specifications

Power supply
via bus coupling unit UP

Transmission rate
9600 baud, 19200 baud

Connection cable
available from authorised electronics stores
(see Example of Usage)

Connections

- 10-pin connector (PEI): for connection to a bus coupling unit UP 114
- RS 232 interface: 9-pin Sub-D plug length of data cable: max. 15 m

Physical specifications

- dimensions (L x W x D):
- DELTA profil: 65 x 65 x 40 mm
- weight: approx. 70 g

Electrical safety

- protection (according to EN 60529): IP 20

Environmental specifications

- ambient temperature operating: - 5 ... + 45 °C
- storage temperature: - 25 ... + 70 °C
- relative humidity (non-condensing): 5 % to 93 %

Location and Function of the Display and Operator Elements

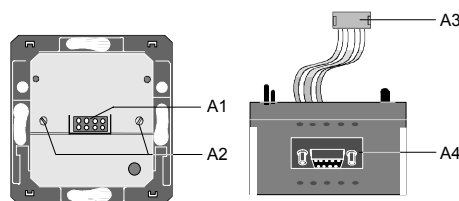

Figure 1: Main module and supporting plate

A1 8-pin socket connector
A2 Mounting screws
A3 8-pin plug-in connector
A4 9-pin interface (SUB-D socket)

Installation Instructions

- The device may be used for permanent interior installations in dry locations within box mounts (in combination with a bus coupling unit UP).

WARNING

- The device must be mounted and commissioned by an authorised electrician.
- The device must not be mounted in box mounts together with 230 V devices.
- The device may be mounted to switch and socket combination box mounts (together with a bus coupling unit UP) if VDE-certified devices are used exclusively.
- The prevailing safety rules must be heeded.
- For planning and construction of electric installations the relevant guidelines, regulations and standards of the respective country are to be considered.

Mounting and Wiring

General description

The interface is slid onto the bus coupling unit UP 114 together with its frame (DELTA profil).

Notes on Figure 2

- The UP bus coupling unit is mounted and connected to the UP box mount (see mounting instructions of bus coupling unit UP).
- The base module (B6) is slid together with the frame (B5) onto the bus coupling unit UP (B1) and mounted to the bus coupling unit UP with the pre-mounted screws (B3).
- The connector (B4) must be inserted in the socket connector (B2) of the basic module (B6).
- Mount the supporting panel (B7) onto the base module (B6) and snap on the cover (B9).
- The cover of the note label (B8) can be removed by meshing into the recesses on its side faces if a note shall be applied.

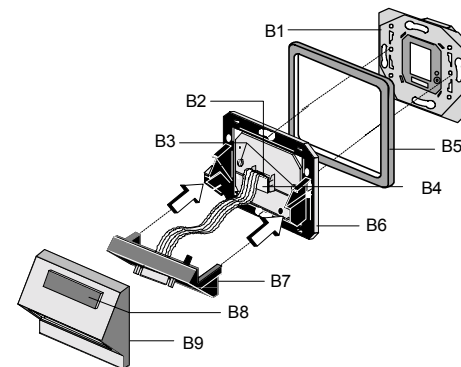

Figure 2: Mounting the interface

B1 Bus coupling unit UP 114
B2 Socket connector
B3 Mounting screws
B4 8-pin plug-in connector with contacting pins
B5 Frame
B6 Base module
B7 Supporting panel
B8 Note label
B9 Cover

General Notes

- Any faulty devices should be returned to the local Siemens office.
- If you have further questions about the product, please contact our Technical Support:
☎ +49 (180) 5050-222
✉ +49 (180) 5050-223
✉ adsupport@siemens.com