

DU 1 DALI KNX

Item no.: 4942580



DALI
DALI gateways and actuators

Description

- Flush-mounted 1-way DALI actuator, KNX TP, Data Secure
- DALI-2 certified
- Interface between the DALI and the KNX bus system
- Simple commissioning of up to 30 ECGs in broadcast mode
- Control of RGB, RGBW, Tunable White or conventional luminaires
- DT-8 luminaire support
- Easy replacement of ECGs in the event of a fault
- Universal mounting thanks to the compact housing
- 2 binary inputs for potential-free contacts such as pushbuttons, switches, window contacts, temperature sensor (input I2)
- The binary input I1 is assigned to the output ex works (function test and operation even without programming)
- Integrated temperature monitoring for increased operational safety, e.g. in case of overload
- Secure communication through support of KNX Data Secure

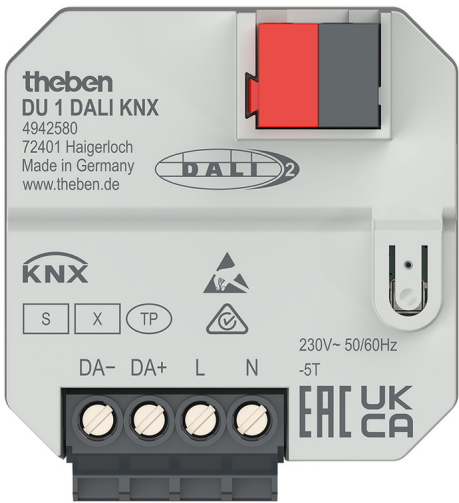

Technical data

DU 1 DALI KNX	
Operating voltage KNX	Bus voltage, ≤ 5 mA
Operating voltage	230 V AC, 50 Hz - 60 Hz
Frequency	50 - 60 Hz
Stand-by consumption	± 0.35 W
Installation type	Flush-mounted
Type of connection	Terminal screws Bus connection: KNX bus terminal

DU 1 DALI KNX	
Number of channels	1
Type	Base module
Ambient temperature	-5°C ... 45°C
Type of protection	IP 20
Protection class	II

Connection example

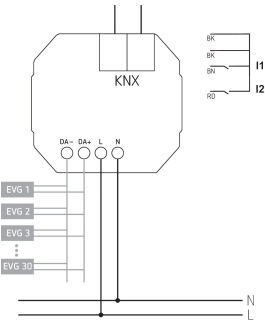

Subject to technical changes and misprints

additional information at: www.theben.de/product/4942580

The load data are determined with exemplary selected illuminants and are therefore typical data due to the large number of available products.

DU 1 DALI KNX

Item no.: 4942580

theben

Scale drawings

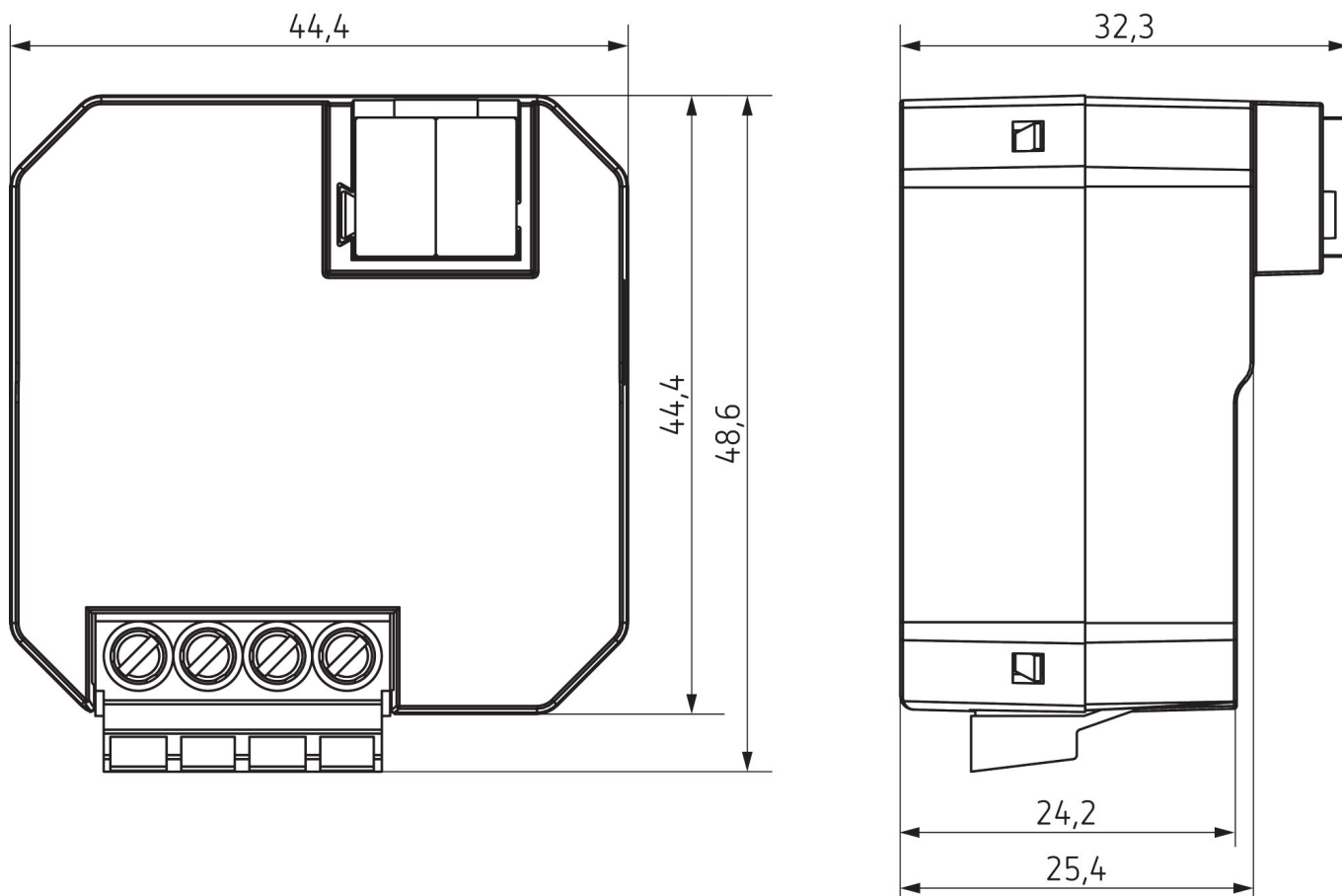

Accessories

Temperature sensor
Item no.: 9070321



Temperature sensor RAMSES IP 65
Item no.: 9070459



Flush-mounted temperature sensor
Item no.: 9070496



Subject to technical changes and misprints

additional information at: www.theben.de/product/4942580

The load data are determined with exemplary selected illuminants and are therefore typical data due to the large number of available products.