



***Design your capacitive
switch TMD in 9 easy steps***

① Register into the web application

Access the on-line application to design TMD: <http://tmd.zennioapps.com>

Click on **Register** and fill the form.

The on-line application will send you a verification link to the specified email address so that you can validate your account. Check your Spam inbox if you cannot find the verification email.

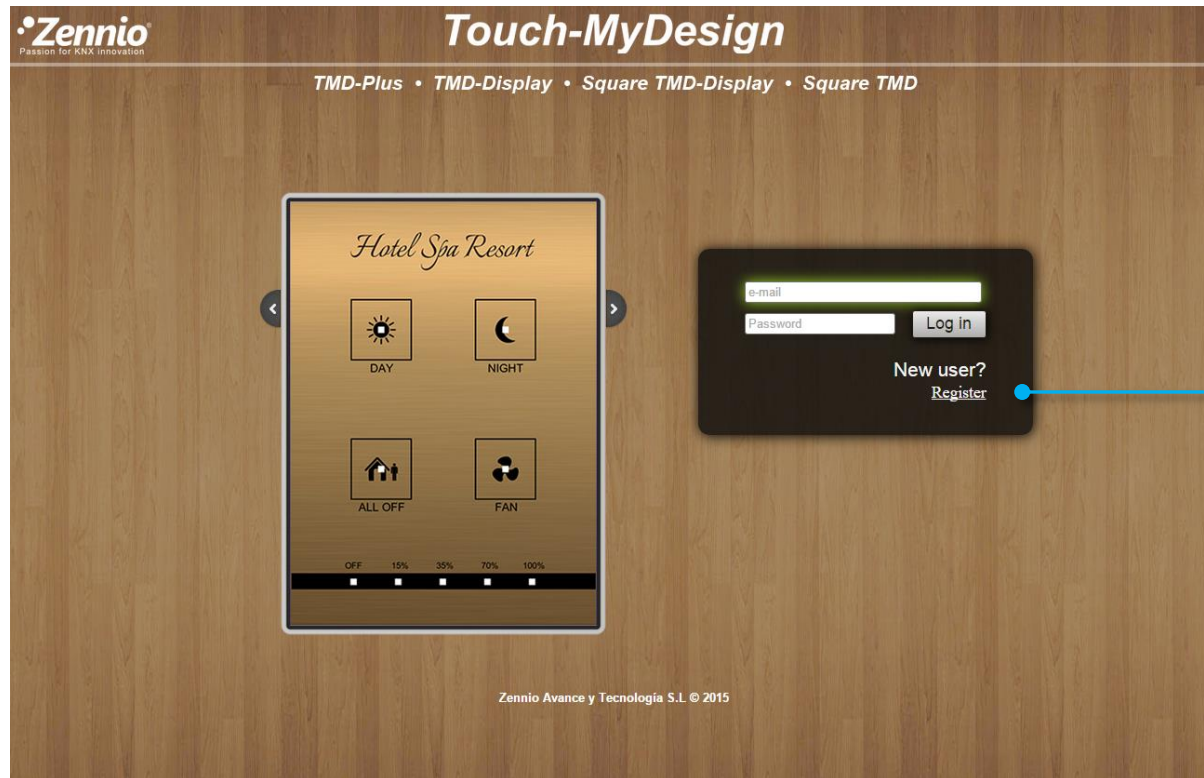

Now you can access the on-line application with your **Email** and **Password**.

② Sort your ideas out

Create **Folders** to sort your projects out

Click on the

- TMD-Plus
 - TMD-Display
 - Square TMD
 - Square TMD-Display
- icon to create a new project

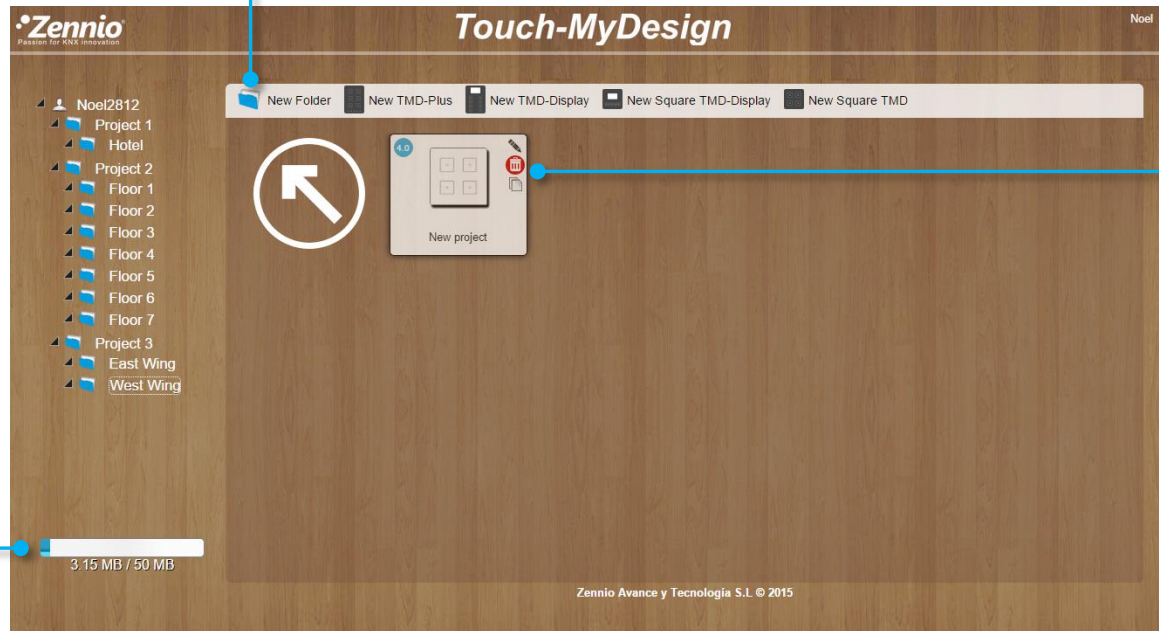

Place the pointer on the project to show the available options:

- Rename
- Delete
- Duplicate

You have **50 MB** available to create your projects

Set a name for your project and click on the project icon to start creating your design.

③ It is time for important decision making

Select the **Number of main buttons**
- Option for TMD-Plus and Square TMD

Set the **Orientation** of your TMD
- Option for TMD-Plus and Square TMD

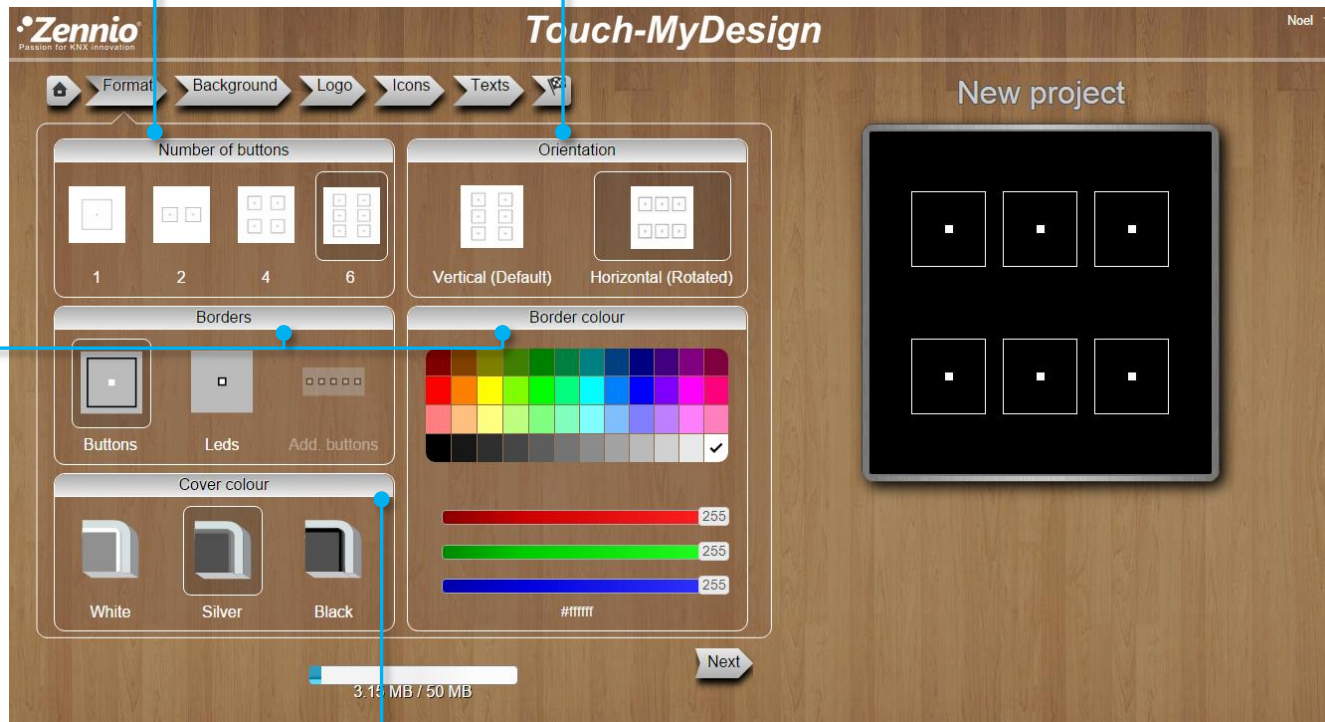

Enable/disable the **Borders** of buttons, LEDs and additional buttons LEDs, as well as the **Border Colour**.

Choose the **Cover colour** that fits the best to your design

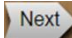
Use the navigation menu at the top of the page or the  button to move to next tab, **Background**.

④ Select the background for your design

You can select an uniform **Background color** for your design...

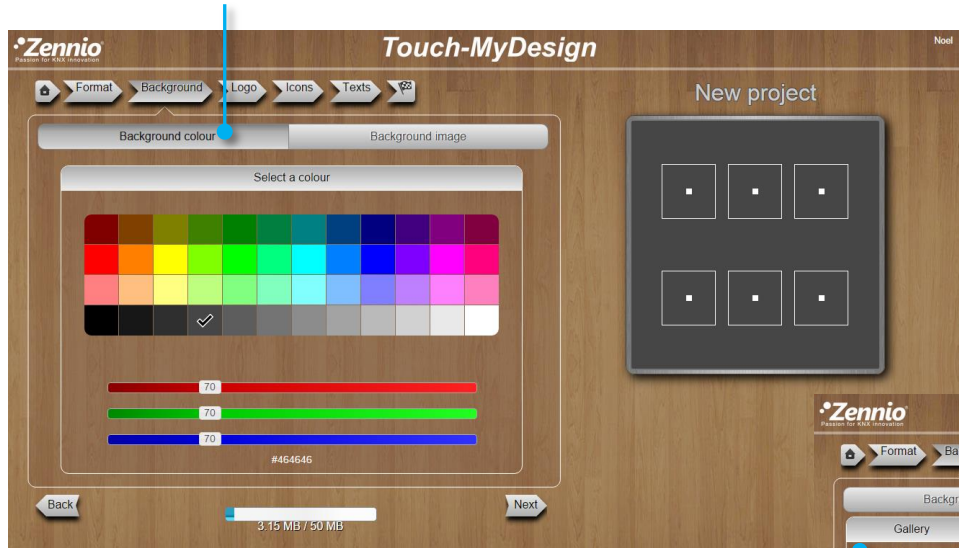

... or choose a customized **Background image**

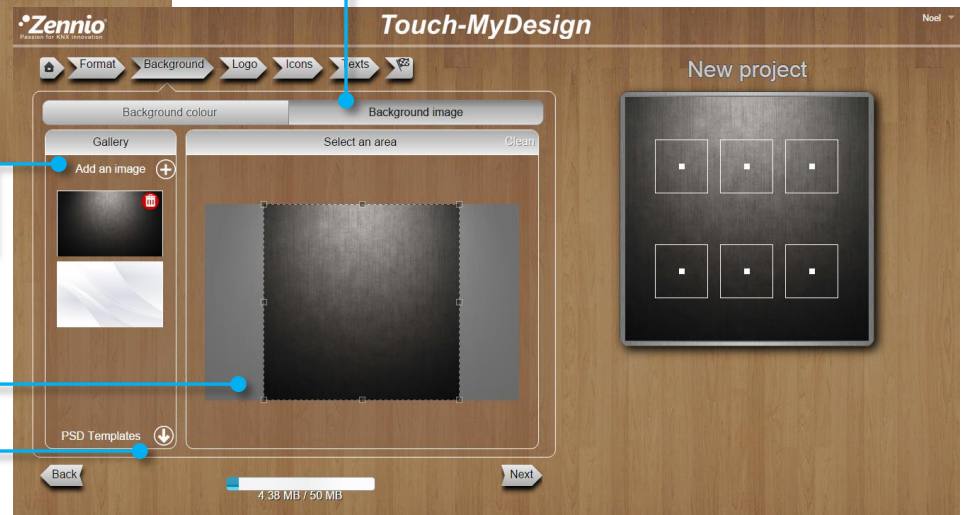

Click here to Add an image

You can select a section of the image as a background

You can use the design software tool you are used to, create your design and import it as a background image. The PSD Templates can be downloaded here to have a reference of dimension and position of the TMD buttons.

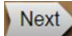
Use the navigation menu at the top of the page or the  button to move to next tab, **Logo**.

⑤ Make your design unique

Add your company logo, customized icons or decorative elements to your design.

1. Click here to add your own images

2. Drag and drop the images to your design area and adjust its size.

3. Use the arrows of your keyboard to place the image in a more specific position.

You can delete elements by dragging and dropping them out of the design area

Use the navigation menu at the top of the page or the **Next** button to move to next tab, **Icons**.

⑥ Select the suitable icon for each button

Select the **size**, **colour** and **icon** that suits better the function of each button. Then, drag and drop the icon to the design area.

Icons Size

Icons Colour

Icons Gallery

If you drag and drop the icon to the button area, it is automatically placed in the middle.

Note that you can add your own icons importing them as Logos in the previous tag “Logo”.

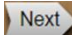

Use the navigation menu at the top of the page or the  button to move to next tab, **Texts**.

⑦ Include texts to complete your design

Select the **Font type**, **size** and **colour** and complete your design with your own texts and labels.

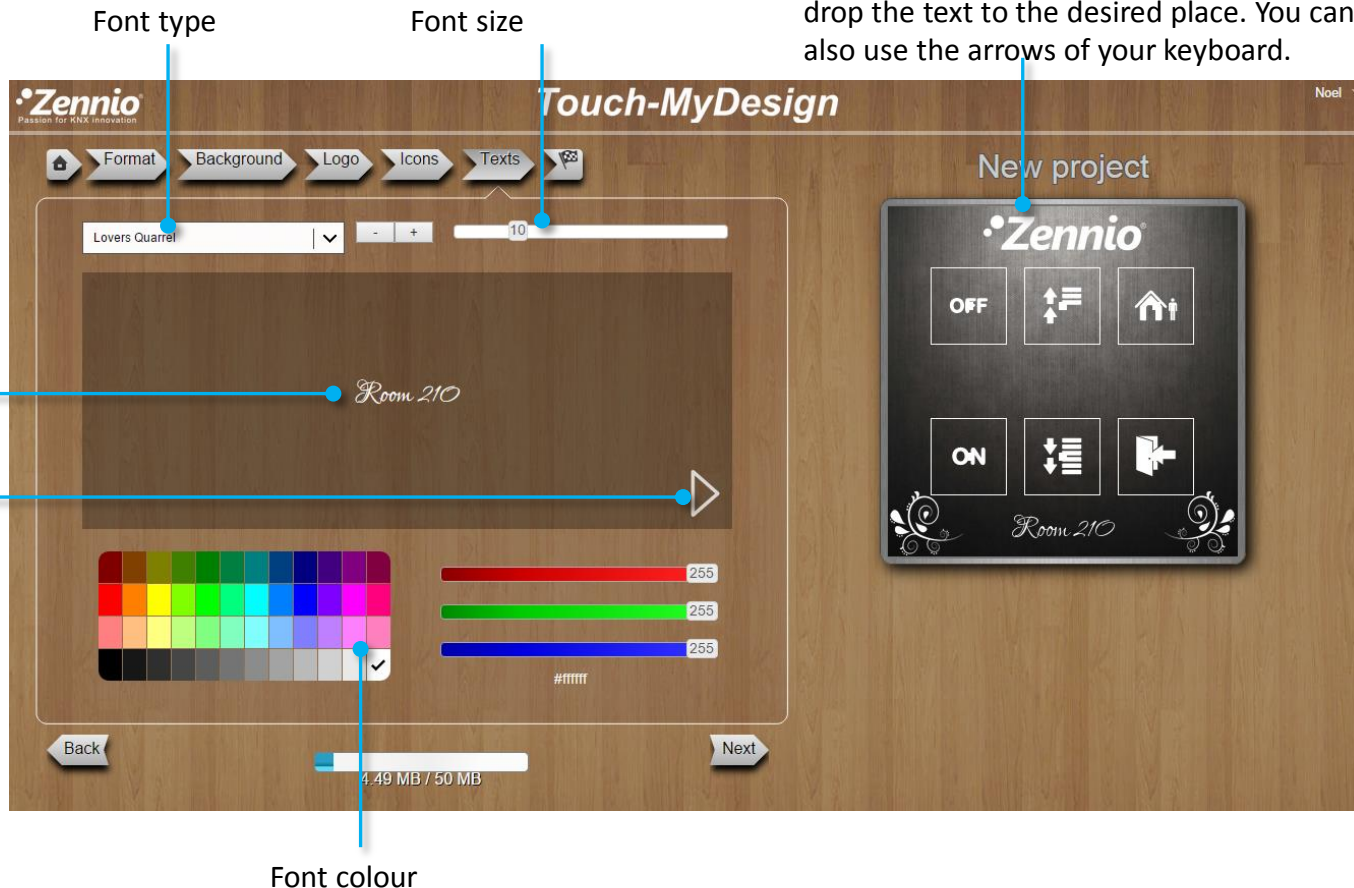
Once in the design area, you can drag and drop the text to the desired place. You can also use the arrows of your keyboard.

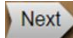

Use the navigation menu at the top of the page or the  button to move to the last tab, 

⑧ See the result

Click on **Preview Project**. A PDF document will be generated to show you the final appearance of the TMD when printed. Review this design to make the desired changes before finishing the project.

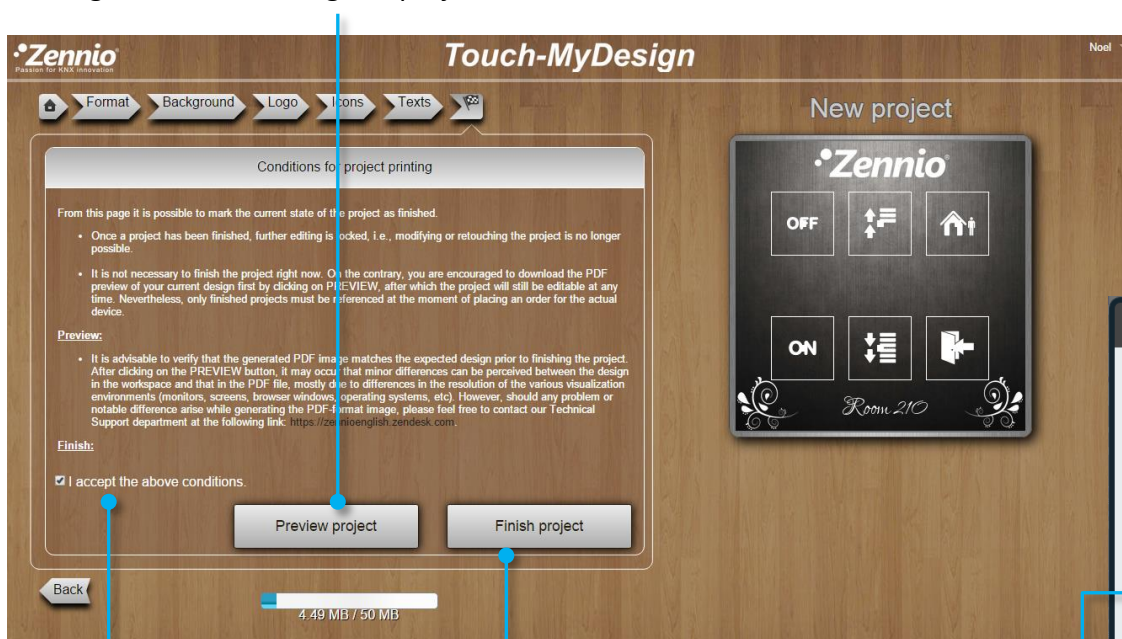

If you are satisfied with your design and you do not need to make changes, **accept the conditions for project printing** to be able to **Finish the project** and continue to select the best frame for your TMD.

If you select the Polycarbonate option, the frame colour will be equal to the cover colour selected in the step 3

A Pop-up will be generated to select the frame

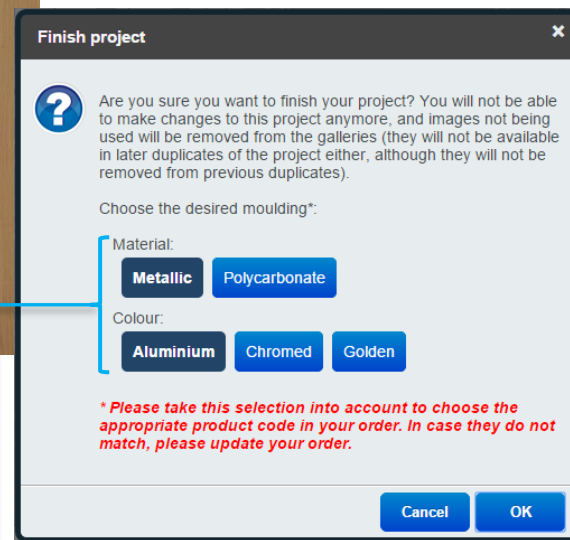

Depending of the TMD that you have designed, you may have different material and colour options for the frame. Notice that this changes may affect the budget, so review your order if necessary.

⑨ Make your TMD real

¡¡Congratulations!! You have finished your TMD design. A PDF will be generated with the instructions to place your order and the design code. Note that once you finish your project you cannot make changes in these design, unless you duplicate the project and edit it.

Instructions to place your order

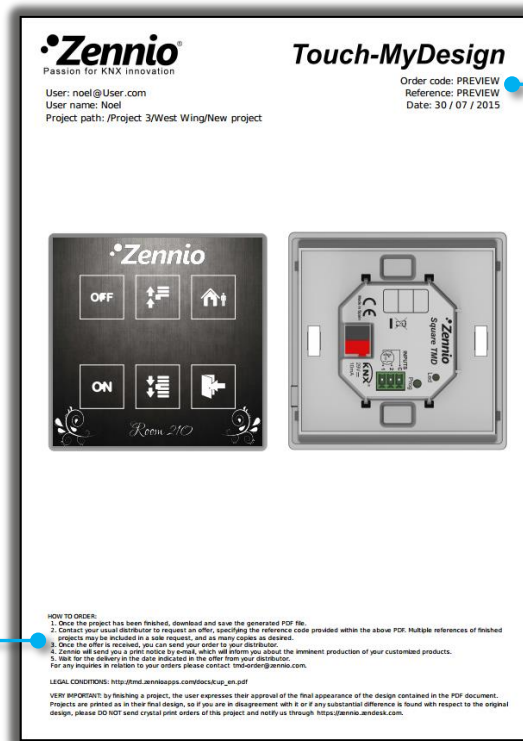

Design code

You will receive an email with this PDF document and the instructions to place your order.