

Tomorrow's aspirations.



**New ideas.
Feel your home
comfort – wherever you are.**

Innovations 2006.

Time for what's most important - for ourselves

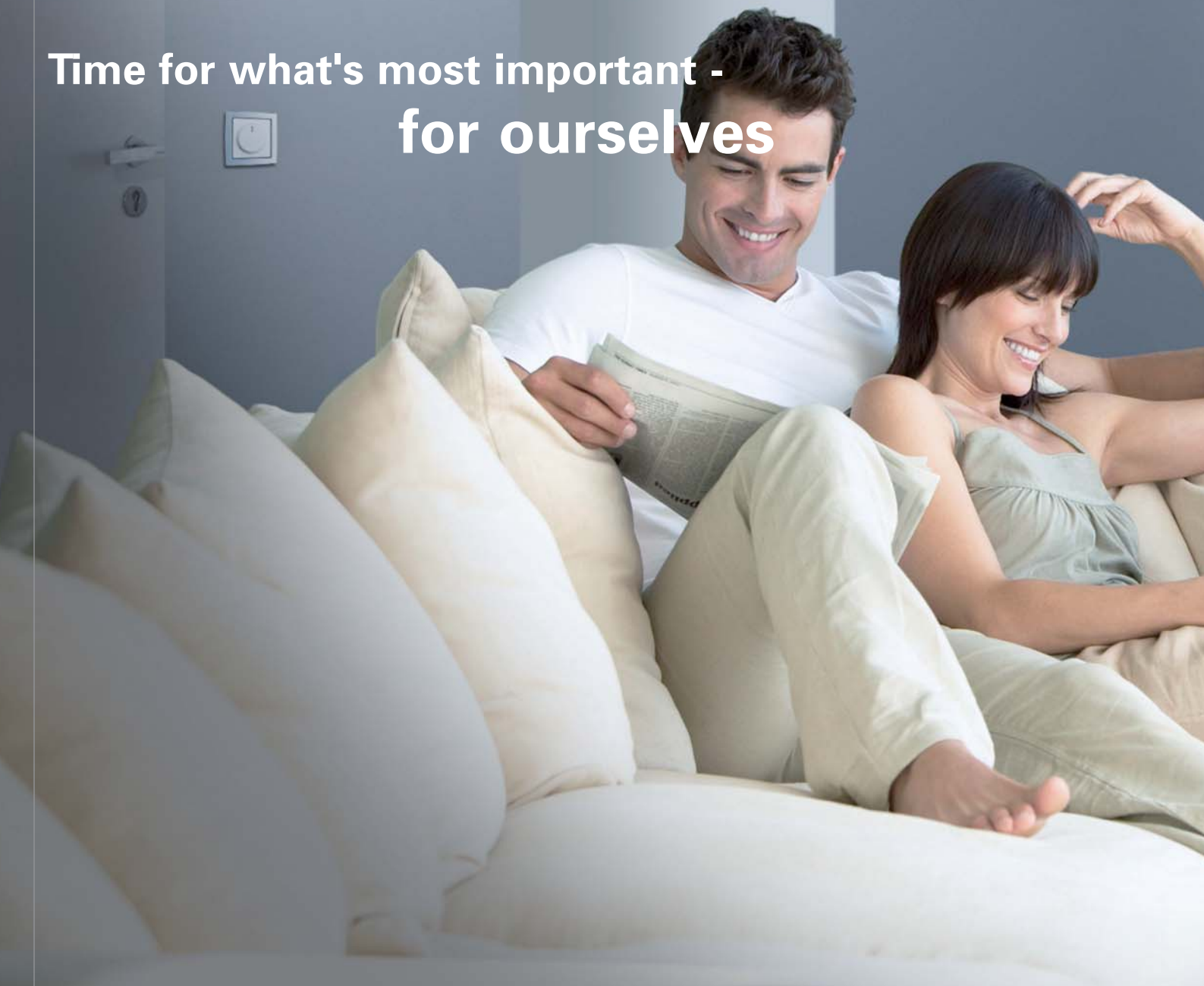

We spend most of our time indoors. In our own homes, at work, in the restaurant, with friends, or on holiday. As a rule we are surrounded by four walls with a roof over our heads. The new Busch-Jaeger products enhance the indoor environment and make the time that we spend indoors safer and more pleasant. For more wellness – and a better quality of life. Just see for yourself!



Switching lights	5–11
Dimming lights, operating blinds	12–17
Controlling and monitoring buildings	18–21
Networking installations	22–23
Informing and warning	24–25
Profiting digitally	26–31



Light can now be regulated in different ways – with just one switch.

Innovation!
The switch with
4 comfort levels.

It can be operated like a normal switch – but offers additional possibilities that have never been combined in this way before in one device. Non-contact, manual or time-controlled switching – functional, versatile and aesthetic - the new comfort switch that offers unparalleled flexibility.



solo®
Busch Comfort Switch

The new Busch Comfort Switch offers different levels of comfort and thus a variety of switching possibilities.

It can however also leave the light on and act as a semi-automatic function, until it is switched off again manually by pressing the button. In addition, the Busch Comfort Switch can also act as a timer. In this case it reacts when a button is pressed and automatically

switches the light off later at a pre-determined time, if it no longer registers any presence. It can even be implemented fully automatically and the light can be switched on and off again if a person is registered.

In addition, the Busch Comfort Switch can be used as a completely normal switch that reacts exclusively to manual operation.

Basic comfort: Switches in the normal way.

Medium comfort: Automatic switching-on function but is switched off by hand – sometimes less automation is preferable.

Timing comfort: Manual switching-on function but with automatic switching-off function – you can determine the length of the time interval.

Maximum comfort: Fully automatic switching.



carat® glass



carat®
stainless steel



alpha nea®



alpha exclusive®



future®



future® linear



Reflex SI



Reflex SI Linear

Medium comfort: sometimes less automation is preferable.

Especially for refurbishments – simply replace existing switch by the comfort switch

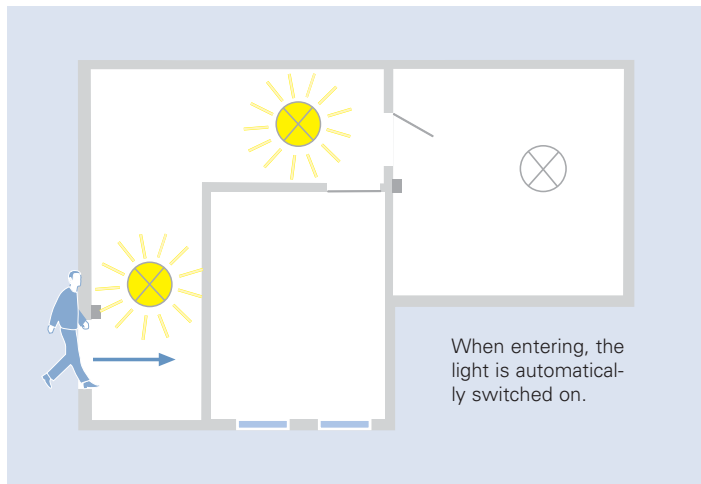

Busch Comfort switch controls the light automatically – but then leaves it on as long as you require. Whether you are sitting still or temporarily leave the detecting area of the sensor, this will not make any difference. One can carry on with one's work without any disturbance and the light does not go out again until the button is pressed.

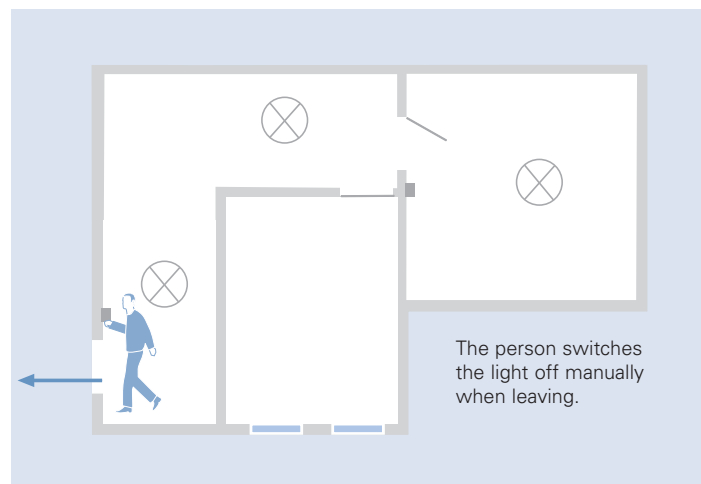
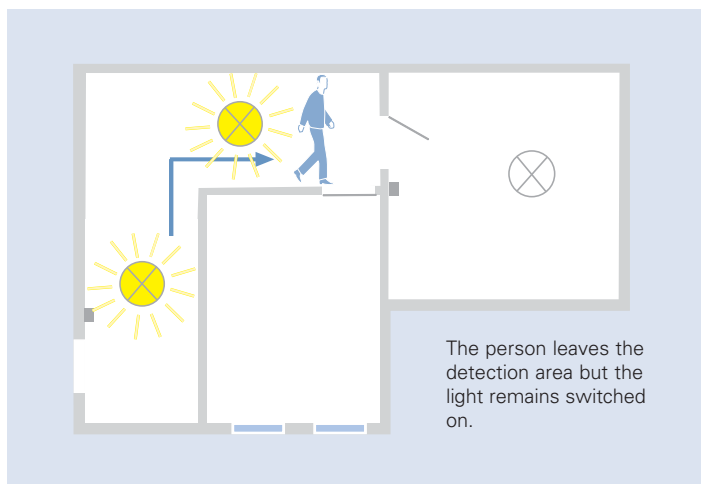

Whether having hands full in the cellar, bathroom or hallway – fully loaded with shopping bags, laundry, crates of bottles – or just enjoying the comfort of hands free switching, using the Comfort switch will help.

Timing comfort: This automatic function does not leave anyone in the dark.

We are all familiar with this: One uses the staircase and the light is still on because someone was in the hallway shortly beforehand. After a few steps one is suddenly left standing in the dark – the pre-set time has ended. With the Busch Comfort Switch unpleasant, dangerous experiences like this are a thing of the past. It recognizes that there is someone using the staircase every time some-

body passes each switch on each floor, and the pre-set switch-on time is continually reset – until there is no one left in the hallway, and one has reached the cellar or the front door.

An LED indicates to anyone entering the hallway that the switch has to be pressed manually. It serves at the same time as a light for orientation purposes and ensures that it can also be readily found in the dark.

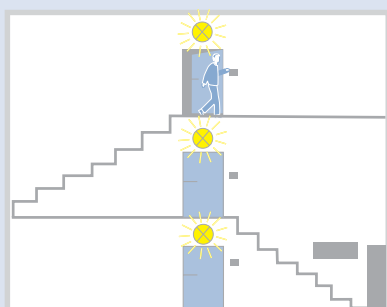

The light is switched on by hand.

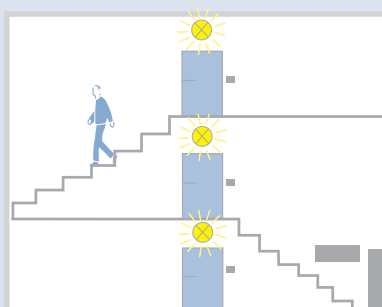

The Comfort Switch recognizes the person going from one floor to the next.

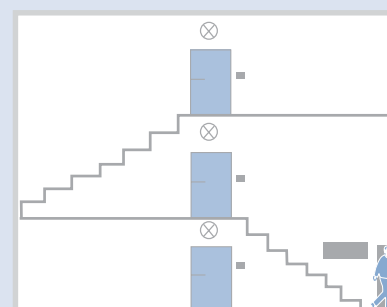

The Comfort Switch switches the hall light off after a pre-determined time.

The light is only on when it is needed – energy-saving, but nevertheless safe and reliable. The light goes on at the press of a button and does not go off again automatically until there is no one left in the hallway – a hall light can be as comfortable as that.



New colours and surfaces – a pleasure for arousing the senses.

This simply has to be experienced: *impuls* and carat® will not only surprise you with its new colours – a special lacquered coating produces an *impuls* surface with a very distinct feeling to touch – there is no other switch range like this. The smoothened carat® edges create a perfect profile.

With the new colours, alusilver and ivory, *impuls* once again offers the possibility of harmonising the latest trends in interior decorating with the visible electrical installations. Ivory is more the classi-

cal, warm alternative for homes in the country house or Mediterranean style house – alusilver on the other hand is cool and modern and ideal for the areas in glass or concrete; both colours set distinct accents in interior

design. The entire range of the devices in the *impuls* Program is available in both new varieties. A special experience is created by the surfaces in alusilver – they are not only extremely hard wearing

and durable – due to their special lacquered coating they have a totally new 'touch sensation'.



impuls
ivory/solargold



impuls
alusilver/chrome

Innovation!
impuls now with two additional colour variations - ivory and alusilver.

Innovation!
carat® in black glass-
 framed design.

A dream in black - the
 material and design of
 the new carat® match
 the control panel per-
 fectly – an unbeatable
 combination.



2-fold combination of switch and socket with integrated,
 increased contact protection. **carat®** Black glass

You will not fail to notice
 the carat® series on the
 wall with its streamlined,
 elegant design. New in
 the program – a black
 glass frame that gives
 an elegant, timeless
 impression. Its polished
 edges ensure a strong
 accent of colour even
 when viewed from an
 angle. The material of
 the new, black glass
 frame exactly matches
 the surface of the con-
 trol panel. In this way,
 harmonious design con-
 cepts can be put into
 effect. All the visible
 components of the elec-
 trical installation form
 one complete entity.

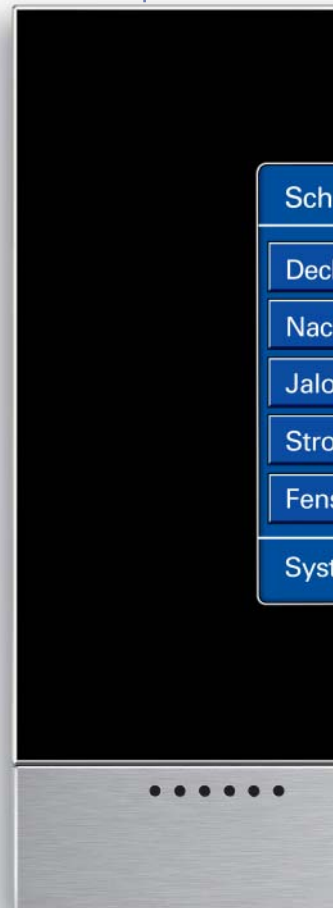

Room and control panel
 Black glass, aluminium plate

A vivid impression – ocean® (IP 44) now also in Alpine white.

Durable material, robust construction and streamlined design are the characteristic features of the water-protected, surface-mounted ocean range. Besides the fresh bluish-green shades, all the products are now also available in Alpine white. As a result, it will be possible to implement the series to an even greater extent.



Alpine white



Alpine white

It is possible to have all the products printed on and additionally to illuminate the switch and push button. The connection space is particularly large and enables leads of up to 5 x 2.5 mm to be fed through below the socket.

In the swimming pool, sauna area, on bright tiled walls, in production areas, or extensions in ocean® in Alpine white is just the right alternative. Besides its versatility the ocean® program offers practical details such as the large connection space for fast, safe assembly, functional safety in cases of

high humidity, or its simple extension to double or multiple combinations. The print-on rocker switch helps to create an overview in the basement hobbyroom, in the laundry room shared by several people or in the production.



Radiant white conveys cleanliness and freshness and is therefore the preferable colour in the food trade – ocean® fits perfectly here.

Innovation!
ocean® now with an additional new colour Alpine white.



Alpine white

The material of all parts of the housing is resistant to aggressive substances such as fat and acids. The material is free of halogen and silicone and due to its extinguishing properties, it offers maximum safety.



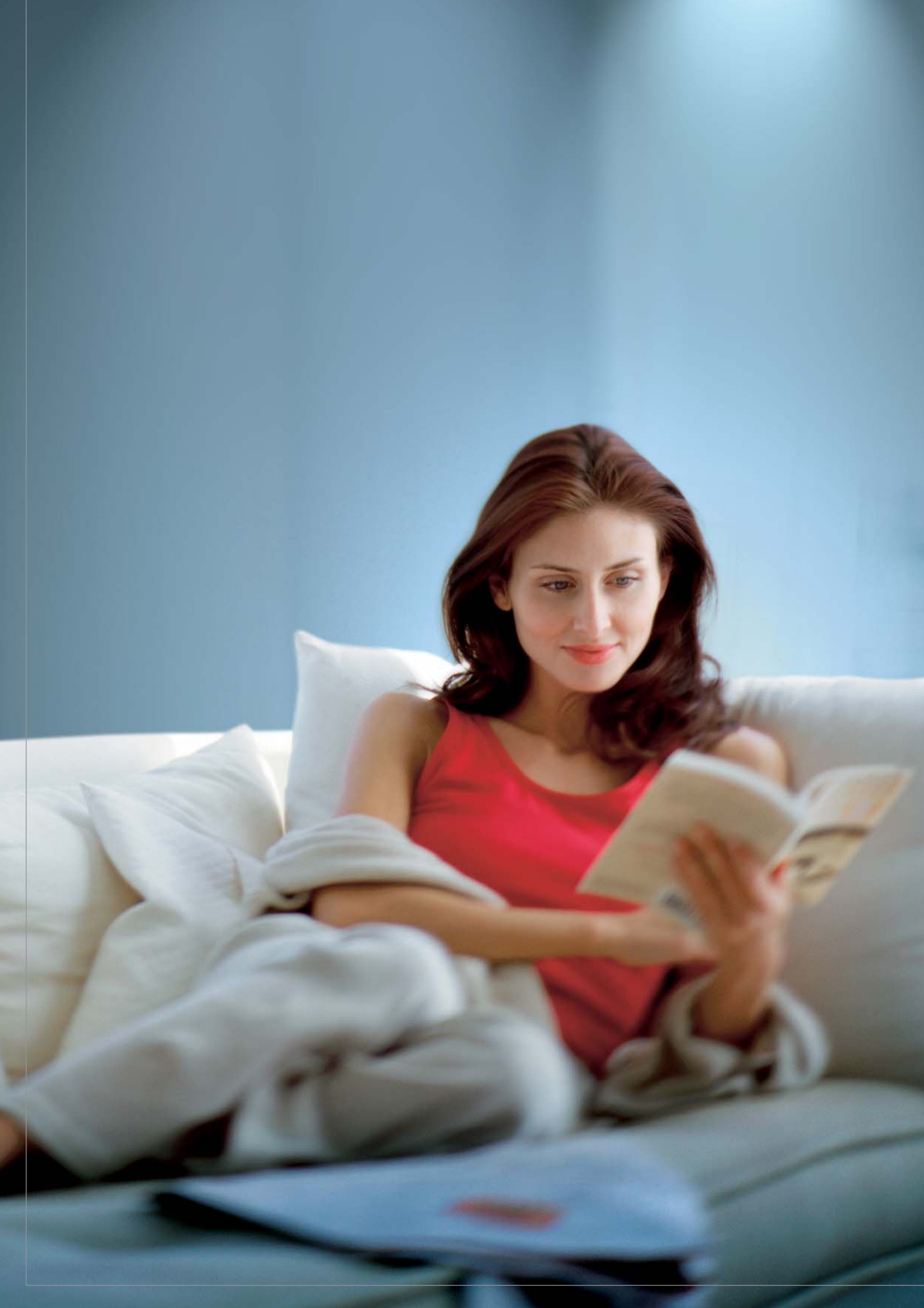

An impressive lighting effect in a double pack – one dimmer for two lamps.

Dimmed light has a direct effect on our well-being; it makes the interior more cosy and creates an atmosphere. With the new Dimmer series, it is possible to regulate two lamps independently of each other at the same time.



Innovation!
Two dimmers in one.

Busch Memory Series Dimmers
solo®, colour: davos

	short	long
left (channel 1)	I/O	↓↑
right (channel 2)	I/O	↓↑

Until now, each dimmer needed its own flush-mounted socket or had to be accommodated in the distributing cabinet – including the wiring. Now this has changed - with the new Busch Memory Series Dimmers two lamps can be regulated from one single flush-mounted box. An available series switch or rotary dimmer is simply exchanged with the new Busch Memory Series Dimmer. This improvement only takes a few minutes – no new leads are necessary. And immediately, light effects can be produced like magic to create a more beautiful interior – simple, elegant and infinitely variable at the press of a button. The

Busch Memory Series Dimmer registers the last level of brightness that was switched on and also switches the lighting on again with exactly the same brightness. An integrated indication lamp ensures that it can easily be found, even in the dark.

The Busch Memory Series Dimmers are available in all the designs and colours of the Busch-Jaeger Switch Program. They are equally suitable for regulating incandescent lamps, halogen lamps or low-voltage halogen lamps with Busch electronic transformers.

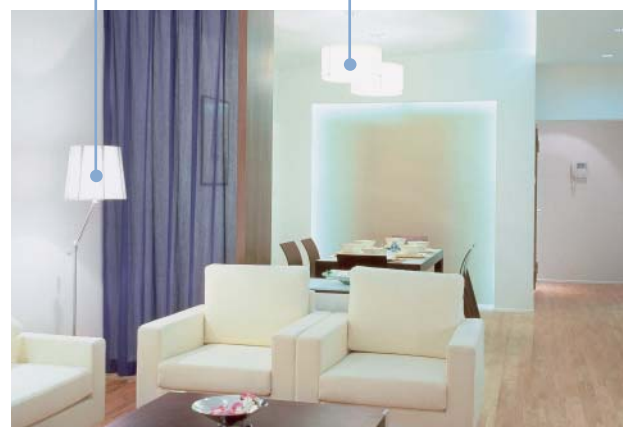

New comfort – The Busch-Timer® for blind and light management.

Intuitive user comfort and aligned automatic functions make the blinds a pleasure to operate with these devices – thanks to a new, clear user guide, the setting is child's play. The date and time are sufficient – the new Busch Timer is now ready for operation. Individual settings are also quick to carry out.



Busch Comfort Timer control cover
solo®, colour: davos



**Extremely flat, the
new Timer fits snugly
on the wall**

The new Busch Timers offer functions that leave hardly any wishes unfulfilled - summer and wintertime are automatically reset and in the case of a power cut, non-volatile memory ensures that individual settings, the time and the date do not have to be entered again.

The integrated Astro Program automatically adjusts the blind times upon request to the sunrise and sunset time. Up to four switching times can be adjusted per day, and by connecting sensors for the sun, or burglar alarm, the building can be protected most effectively against damage.

The holiday function creates the impression that the house is occupied, even during longer periods of absence.



For start-up the operating element can be removed and held in the hand. After entering the date and the time, the device is ready for operation.



In the top line, one can read the value that now has to be set.



By lightly tapping the floating central disc one can navigate safely through the menu.



Block switching is possible, i.e. switching the same times for a block of several days.



The Comfort version additionally offers the possibility for connecting a brightness sensor and shows its measuring value - presented on the display by a sun symbol and a bar on the left-hand side.

New comfort!
Intuitive operating comfort and aligned automatic functions.



The modular construction of the entire product line enables different flush-mounted devices to be combined with different variations of timer. An important advantage of the new concept - a mechanical operating element can be replaced at a later time without any problem by a Standard or Comfort Timer without

changing the flush-mounted inserts. UP-E Not only blind management is rendered possible in this way. Together with the Timer, a Dimmer insert can also ensure that lamps can be switched to different levels of brightness at the switching times. Even pond pumps or the external lighting can

easily be controlled via the Timer in combination with a relay insert.

Busch Blind Basic Insert 6418 U

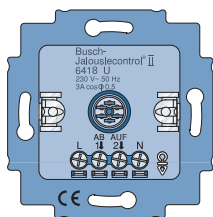

Busch Blind Control Insert S 6411 U-101

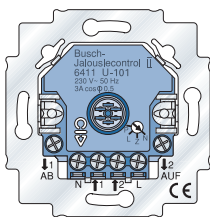

Busch Blind Control Insert S 6411 U/S-101

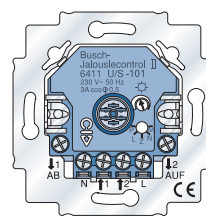

Burglar alarm sensor 6413

Brightness sensor 6414

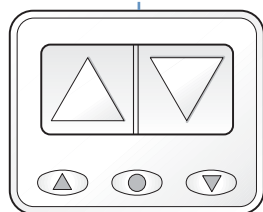

Memory operating element 6457



Standard Timer operating element 6456

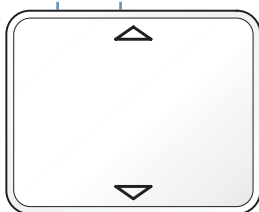

Operating element 6430-xxx-102

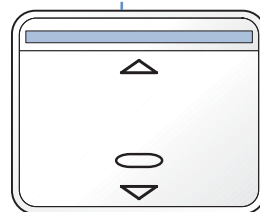

Operating element 6066-xxx-10xIR-B



Comfort Timer operating element 6455

Modular technology – Dimmers with system.

Easy to assemble and multi-functional - this concept is convincing: ready-prepared cables connect dimmers and power elements, and different modules for the central operation can be fitted without using any tools.

A new generation of the successful Dimmer System is here - and it is now even easier to assemble as the power elements have a ready-prepared cable enclosed that only has to be inserted. REG-D
As a result, not only the installation time is reduced - wiring errors are also avoided. A further plus point - the status display is now located on the visible cap so that one can see at a glance if everything is correct. Not only push buttons can be connected - it is also possible to install up to five rotary dimmer exten-

sions. And best of all - three different modules for comfortable operation directly on the device can be mounted on the dimmer quickly and easily by hand. REG-G

A timer is also available next to the push buttons and rotary operating elements. Its text display enables easy programming; consequently, the occasional user can also carry out settings on the year-setting switch. 48 memory spaces and special programs such as holiday, basic brightness, night light, cycle or glass cab-

inet are available. These enable sophisticated lighting solutions, e.g. for shop windows or hotel foyers. Due to the modular concept, the Timer can be retrofitted at any time - this flexibility leaves all the options open during the planning phase.

More comfort and flexibility!



For connecting the individual devices, a ready-prepared cable is enclosed with each central module. This facilitates the assembly and prevents wiring errors.



6584

6583

Up to six power modules can be connected to one dimmer. In this way, loads of up to 3000W/VA can be regulated by one single dimmer.

The covering cap located on top of the dimmer can be exchanged by insertable modules. A push-switch control cover, a rotary control cover and a timer can be chosen. In this way, one has a comfortable, central operating possibility.

The decentral push-switch and rotary control covers can also be blocked, if required, when using the Timer module.

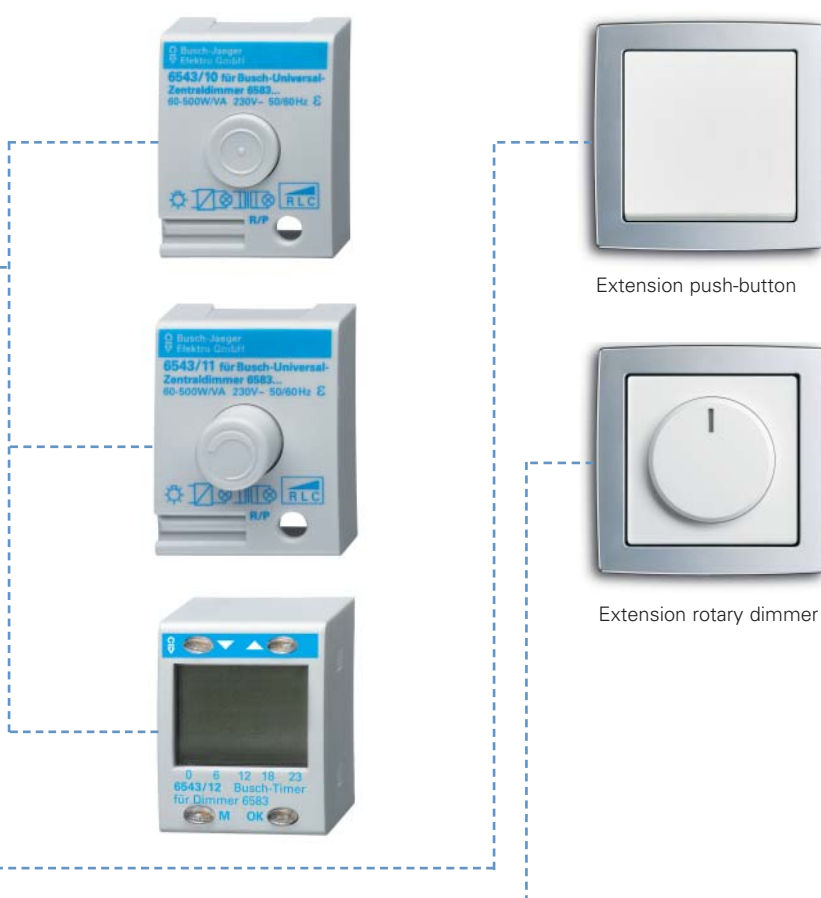

Extension push-button

Extension rotary dimmer

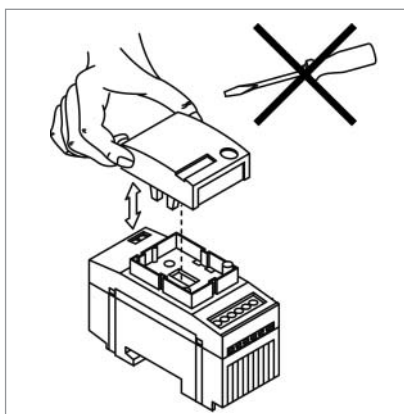

The different modules can be mounted without using any tools by simply snapping them on.



Controlling, warning, monitoring – Comfort on the highest level

The control panel enables the entire home technology to be governed from a central point.

It is simple to operate and its design enhances any interior.



Room and control panel

Genuine glass frame, black with chromium plate

The control panel provides maximum comfort – a central switching location allowing the entire technology in the home to be monitored and regulated. It can be implemented for arranging and calling up entire scenes.

New: Audio and video devices can now also be controlled via the control panel in combination with an additional device and integrated in the

scenes. The operation of the control panel via an infrared hand-held transmitter is particularly comfortable; it can control up to ten connected devices or functions. The development of the device has also been enhanced where user-friendliness is concerned - the clear overview on the screen shows up to ten touch surfaces or eight operating buttons that can be

activated with the finger tip or a pen. PDA-S It is even possible to record user-defined scenes as so-called macros, i.e. complete sequences. The technology that lies behind it is based on the EIB/KNX system that also offers the possibility of transmitting information via the available power supply system. KNX-S In this way hardly any new cable has to be laid if one wishes to enjoy the benefits of the control panel.



Texts and pictograms

make the operation of the control panel particularly easy.

Room and control panel
New varieties of design with
an extended scope of functions.

Up to 210 switching and controlling functions are now available that can be clearly presented on large format sheets and sorted according to rooms or consumer groups. Besides freely selectable texts and the available pictograms even own symbols can be used for illustrating the touch surfaces. But not only the functions of the control panel have been extended –

even the elegant design has been enhanced by implementing perfectly machined, genuine glass surfaces. Three different versions are now available. The genuine glass frames can be chosen in black or white and thus matched perfectly to the carat Switch Series that has genuine glass frames in the same colours. For the black version, one can choose between a chromium or aluminium

plate. The white version is only available with an aluminium plate.



Room and control panel

Genuine glass frame, white with aluminium plate



carat® white glass

The style of the control panel ideally supplements the carat®; as a result, the entire electrical installation in one room can be optically matched.



Room and control panel

Genuine glass frame, black
with aluminium plate

An overview of the entire
home: The numerous func-
tions of the control panel
fulfil the highest demands
for comfort and safety.

carat® black glass

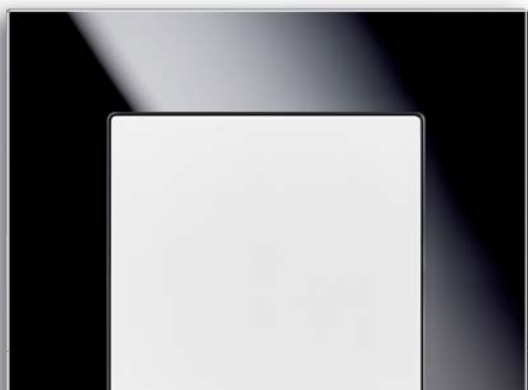

All the benefits of the new Busch Watchdog now also for EIB.

As a result, the diversity of the surface-mounted Watchdogs wins an additional feature: The Busch Watchdog 220 EIB ProfessionalLINE is outstanding due to its intelligent functions – above all, the surveillance zone that can be set using the software.



Busch Watchdogs
220 EIB ProfessionalLINE



This device has already been a star in the conventional sector for a long time; now there is also the ProfessionalLINE-Watchdog for this device, that can be used in the EIB/KNX-System. The 220 is the all-rounder amongst the Watchdogs and can monitor narrow terraced house entrances just as reliably as the larger entrance spaces. In addition, the surveillance zone can be changed using the soft-

ware – as an alternative it is possible to cover the lens. A large number of different functions are available, of course – for instance, an integrated warning or daylight function allowing for the application of a device as a daylight sensor. The follow-up time can be set either via the ETS (EIB Tool Software) or via a potentiometer on the device – in this way, it can also be adapted quickly during operation.



white



silver

The Busch Watchdogs
220 EIB ProfessionalLINE
are available in 2 different colours.

New accessories for the EIB/KNX-System.

With these innovations the EIB product range has become even more versatile - the time transmitter, brightness and temperature switches, and a regulating valve open up new application possibilities for bus technology. EIB-P



The new time transmitter sends the time and date to the EIB/KNX-bus and thereby supplies the users with the latest data. The switch-over from summer to wintertime takes place automatically, and a follow-up time of 10 years can be ensured by buffering. For synchronising, a DCF aerial can be connected – however, the device also functions without it. DCF-A



The brightness and temperature switch 3gang records brightness and temperature and shows these values on the bus. In addition, the device has threshold switches for both the parameters; consequently, it can be implemented excellently for controlling strip heaters or shading systems in conservatories or greenhouses.



Actuator
The correct temperature automatically - the thermoelectric actuator in the new design serves, together with a heating or a switch controlling

element, to control heating, and cooling roofs. The function display clearly shows whether the actuating mechanism is open or closed.



Be better informed at a glance – the Info Light.

The Busch Info Light informs you and provides clear orientation in an unobtrusive way. A special section with an illuminated pictogram marks the WC, indicates non-smoking zones, or gives information on rooms for special purposes. The Busch Info Light is helpful everywhere.



Busch Info Light

future® linear, colour: anthracite

With the new Info Light, Busch-Jaeger offers added safety and comfort both in rooms used by the public and in private households. With its impressive, durable LED technology it facilitates orientation and provides information in hotel corridors, in business establishments and in gastronomy, as well as in the waiting rooms

at doctors' surgeries or lawyers' offices. LED-T The Busch Info Light enables localities and application areas to be marked from the outside in the style of the respective electrical installation. The homogeneous illumination in the middle section alone provides sufficient orientation in dark corridors and stairways.



carat®



solo®



alpha exclusive®



future® linear



Reflex SI Linear

The Busch Info Light is available as an insert to match all the flush-mounted switch ranges. Included in the delivery are 46 pictograms and printed information for the most common applications.

Fine, if they're seen in good time – systematic alarm and alarm response.

The wish to live in a home that is comfortable and safe is often difficult to fulfil, particularly for the elderly and handicapped persons. Here, the Busch-Infoline® System by Busch-Jaeger helps to fulfil this wish.

Busch-Infoline® is an alarm and alarm-response system for a large number of applications. Emergency call systems for handicapped toilets, call-for-help signals in public areas, private/domestic nursing facilities, or for monitoring dampness in kitchens or cellars, just to mention only a few.



Busch-Infoline® Alarm warning insert
future® linear, colour: studio white

New!
Now also available
for the switch ranges
solo®, future®,
future® linear,
Reflex SI/SI Linear.



Busch-Infoline® Alarm warning insert
solo®, colour: davos



The control display signals
up to 6 independent alarm
or status signals. Using the
push buttons that can be
printed-on or colour-coded,
the alarm signals can be
actuated by a pull cord.

One step ahead again – new standards for launching on the net.

World-wide presence, both day and night – Busch-Jaeger faces the challenge of behavioural changes in information supply. The new Internet presence fascinates end users and specialists alike.

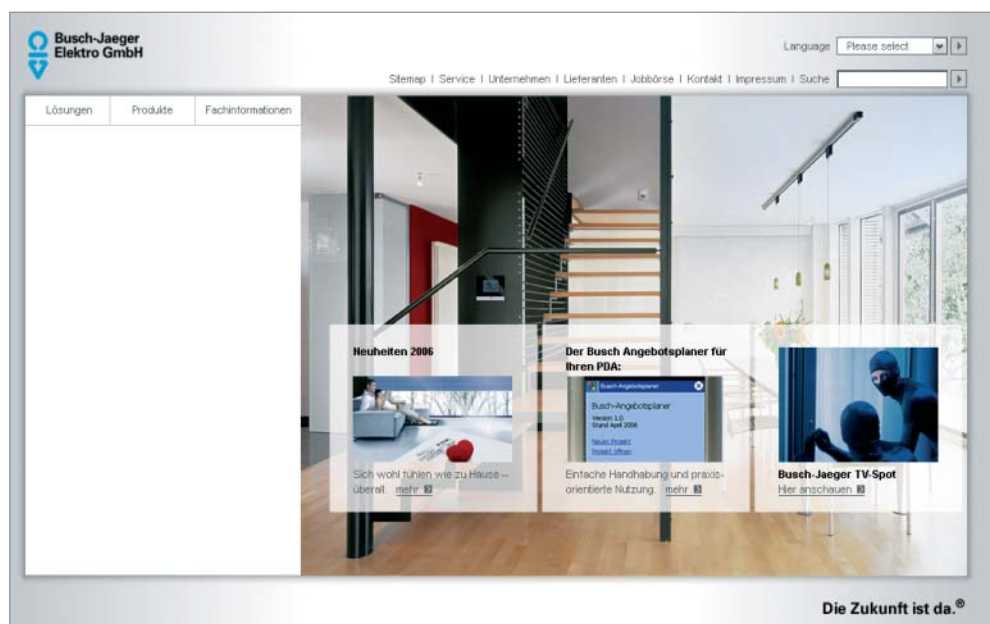

The latest news comes first: The latest information is found on the very first page. The regular visitor is rewarded with updated contents on the products and the company.

Internet relaunch
Practical. Comfortable.
Clear and more concise.

Less is often more effective – on the screen particularly, it is the most essential information that is needed. Design and content must be clearly shown and easy to assimilate – the eyes must not be dazzled by too much.

This is exactly the path that Busch-Jaeger is taking with its new web presence. The colours, design and terms in the texts are also found again

on the Internet – at a glance, one gains an overview of the new structures and quickly finds all the information one is looking for. It is not only entered there as an electronic catalogue or brochure ready for downloading – the beneficial use of the products is also presented in demonstrative films. In this way, the wishes of the owners are aroused for modern solutions and an electrical installation

that is up-to-date. And a place is also reserved with sufficient technical information for the specialist.

The latest software, specifications, circuit diagrams or dimensional drawings – everything that one needs to know about Busch-Jaeger products is readily available for the visitors on the Internet, around the clock, seven days a week.

In impressive flash films focusing on the applications, it is shown how the Busch-Jaeger solutions can help to provide more comfort, greater safety and reduce costs.

Anyone looking for information on specific products quickly finds the information he wants this way – the entire range is presented under this menu navigation item.

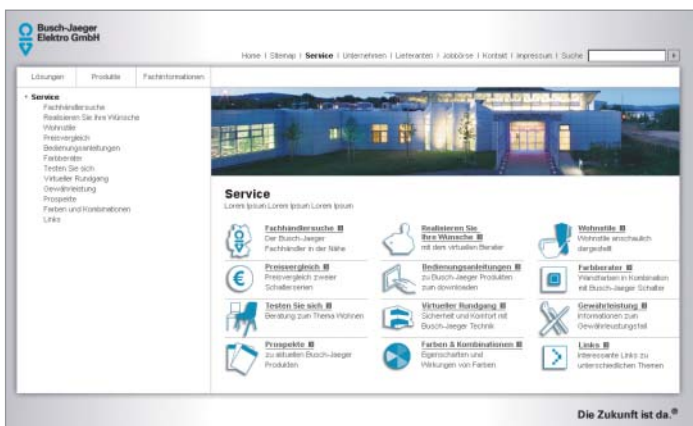
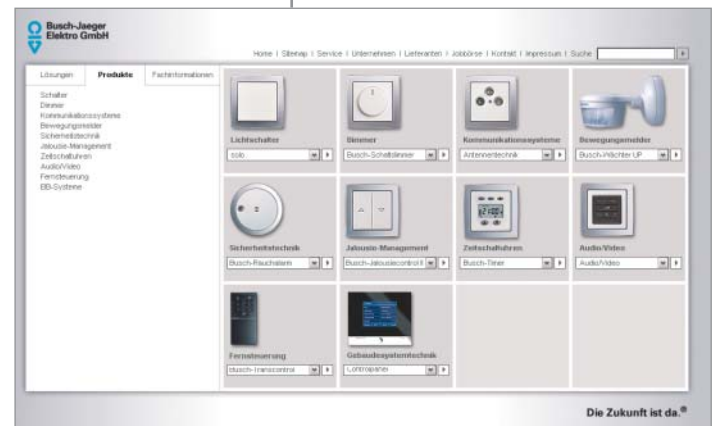
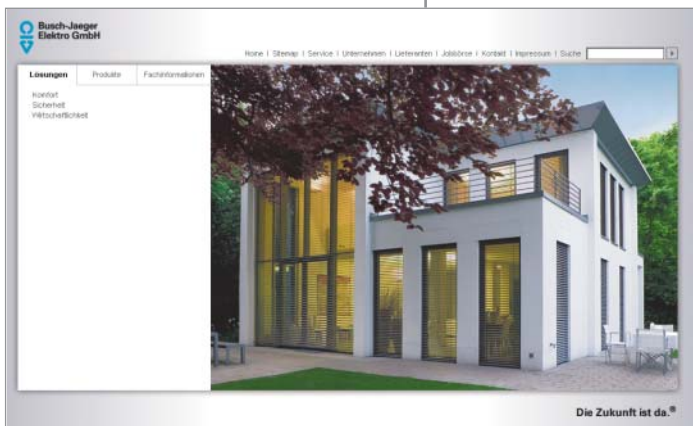

In the Service section a great deal of useful information can be found for all the users. Specialist dealers can be found here, or price comparisons can be made between the individual Switch Programs.

www.Busch-Jaeger.com

A member
of the ABB Group

Busch-Jaeger Elektro GmbH
P.O.Box
58505 Lüdenscheid

Freisenbergstraße 2
58513 Lüdenscheid
Germany

www.Busch-Jaeger.com
info.bje@de.abb.com

Central sales service:
Phone: +49 (23 51) 9 56-0
Fax: +49 (23 51) 9 56-13 80

Busch-Jaeger products are available at your electrical specialist